

LED VANITY BATH BAR, SELECTABLE 5CCT  
ITM: 1019-1S-XX-LED,1019-1S-XXXX-LED



## FOR YOUR SAFETY WARNING

**Risk of Fire, Consult a qualified electrician to ensure correct branch circuit conductor. Turn off the main power at the circuit breaker before installing the fixture in order to prevent possible shock.**

### General

**All electrical connections must be in accordance with local and National Electrical Code (N.E.C.) standards. If you are unfamiliar with proper electrical wiring connections, obtain the services of a qualified electrician. Remove the fixture and the mounting package from the box and make sure that no parts are missing by referencing the illustration.**

1, Carefully slide the glass shade into the front aluminum fixture while supporting the glass shade.

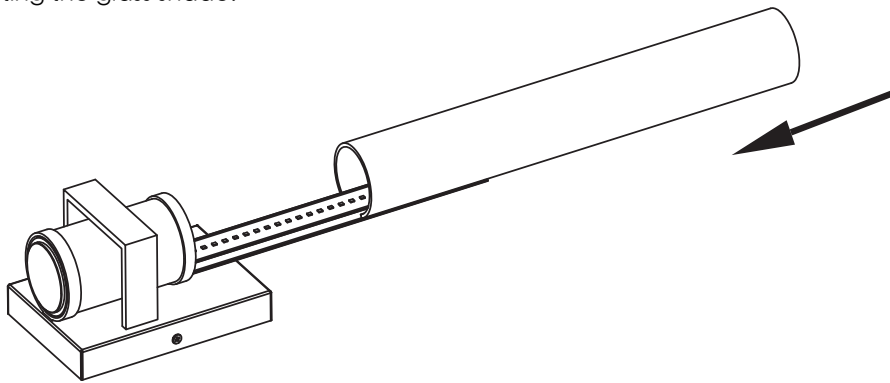

2. Attach the two glass holders to the front aluminum fixture.

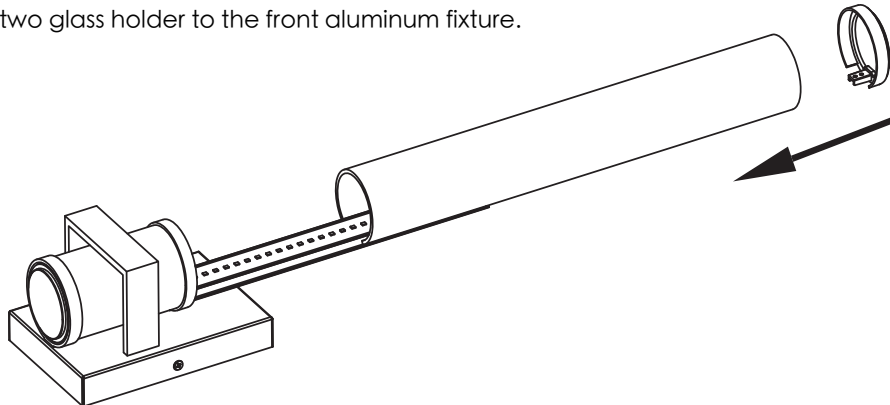

3. Install the glass holder with the 2PCS screws to secure the glass shade in place.

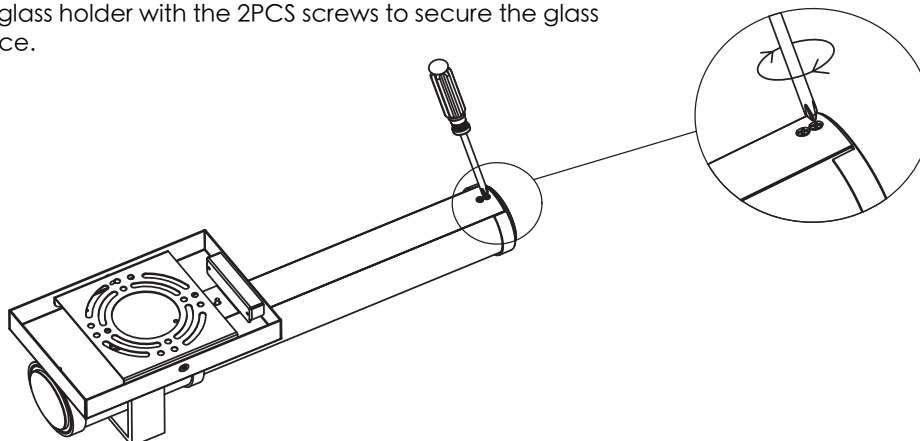

**“To clean, wipe fixture with a damp soft cloth. Then dry immediately with a dry soft cloth. Clean glass with a mild soap. DO NOT use chemical cleaners or abrasive materials such as scouring pads or powders, steel wool or abrasive paper.”**

**LED VANITY BATH BAR, SELECTABLE 5CCT**  
**ITM: 1019-1S-XX-LED,1019-1S-XXXX-LED**



Please consult a qualified electrician for hanging fixture and wiring.  
**CAUTION:** Before starting the installation, disconnect removing the fuse at the fuse box.  
 Carefully unpack and identify all parts before assembly.

4. Follow wiring instructions Fig.3 and Fig.4

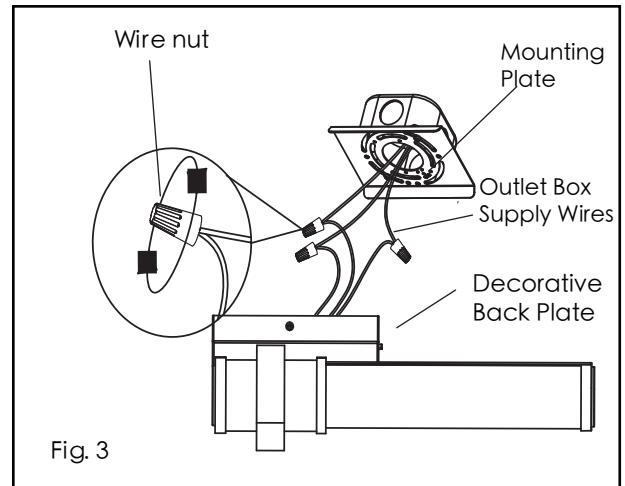
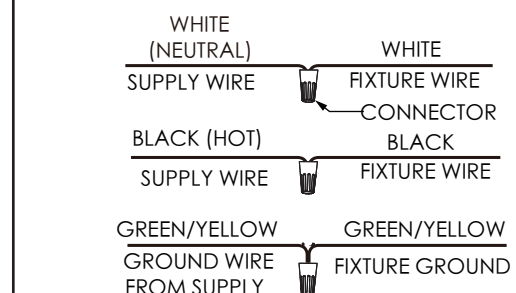

Fig. 3

Fig. 4 Wiring guide



5. After connecting all wires, push all wires and wirenuts back through center hole of mounting plate and into the cavity of the electrical box, while positioning the fixture to align with the mounting points / tabs.
6. Secure decorative back plate with screws at the top and the bottom to the mounting plate. (See Fig. 5)

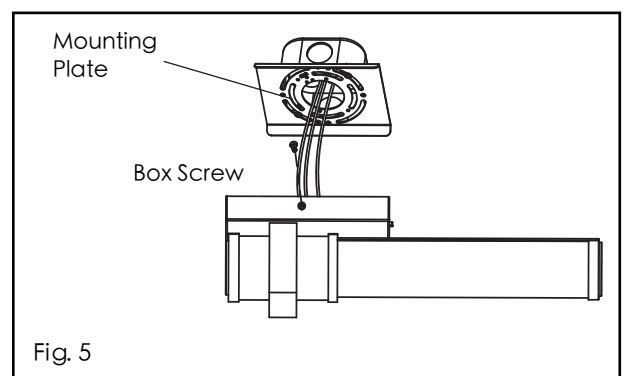
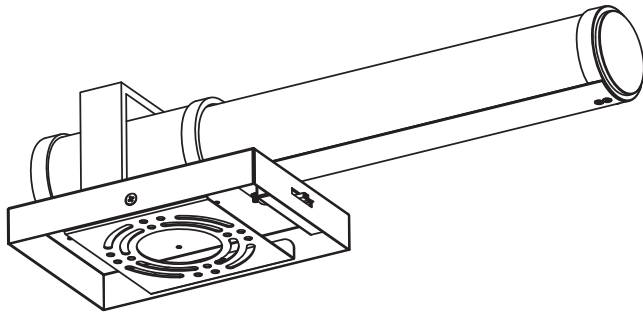
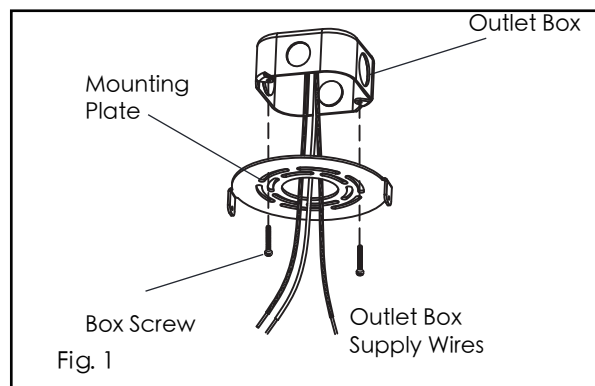

Fig. 5



1. Always disconnect power at the main electrical panel before installation.



2. Pull wall box wires through center hole of mounting plate. Secure mounting plate to wall using screws so that the fixture mounting points are aligned vertically. (See Fig. 1)

Turn off the light before Switching.

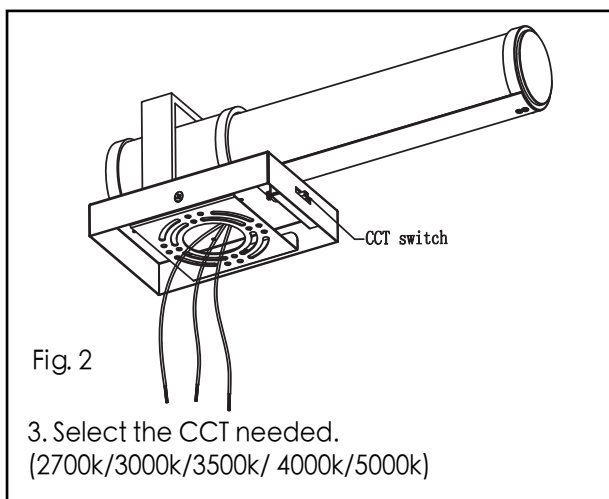

Fig. 2

3. Select the CCT needed.  
 (2700k/3000k/3500k/ 4000k/5000k)