

LEANO 15 MONORAIL OR FREEJACK PENDANT

920SLPD771-MO-FJ-MP

SLPD771MO; SLPD771FJ; SLPD771MP

General Product Information

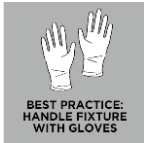
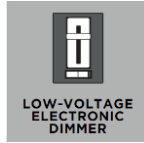
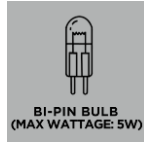
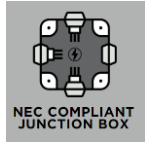
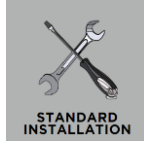

Note: Designed for use only with Visual Comfort & Co. FreeJack canopies or MonoRail systems.

Suggested/Required Tools



Safety Information

CAUTION-RISK OF FIRE

This product must be installed in accordance with the applicable installation code by a person familiar with the construction and operation of the product and the hazards involved.

USE MINIMUM 90°C SUPPLY CONDUCTORS.



Turn off electrical current at the source before working with any lighting fixture or portable lamp. Install and use this product in adherence with local electrical codes and regulations.

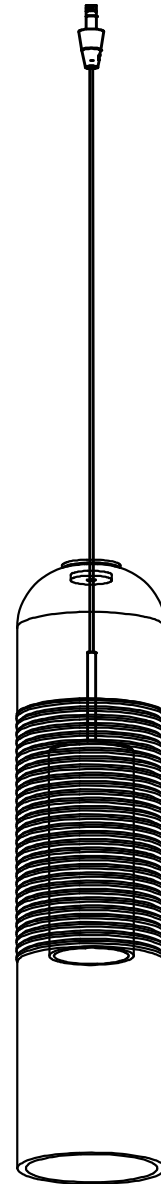

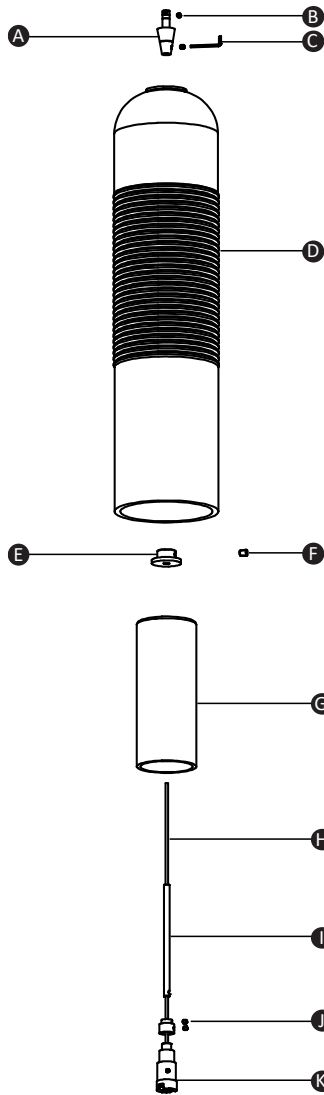

## FIXTURE PARTS

- A. FreeJack Male Conical Connector
- B. Conical Connector Set Screws
- C. Allen Wrench
- D. Glass Shade
- E. Fitter
- F. Fitter Set Screw
- G. Diffuser
- H. Coaxial Cable
- I. Cable Shield
- J. Strain Relief with Set Screws
- K. Socket
- L. LED Bi-Pin Bulb (Not Illustrated; Purchased Separately)

### Bi-Pin Bulb Replacement Instructions — Refer to socket for max wattage information. Replace as needed after installation and during use:

⚠ Turn off power before servicing to avoid electrical shock or burns.

1. Raise the outer glass shade and inner diffuser to access the socket.
2. Then take out the used bi-pin bulb.
3. Lower the cable shield, diffuser, and glass shade back into position to finish.

## INSTRUCTIONS

### I. Installing the MonoRail FreeJack Connector or FreeJack Port with Canopy

1. See linked installation instructions included with purchase of [MonoRail FreeJack Connector](#) or [FreeJack Port with Canopy](#).

### II. Adjusting the Fixture Cord Length

1. Loosen (do not remove) and back out the set screw at the tip of the connector. If removed, it is difficult to reinsert and easily lost. Then loosen the set screw on the conical connector.
2. Pull out the coaxial cable from the fixture and cut it to the desired length.
3. Gently twist the end of the cable between your fingers and tap the conical connector (set screw side down) on a hard surface to seat the internal plate.
4. Feed the coaxial cable into the conical connector until it stops (~ $\frac{3}{4}$ ").
5. Push and twist the connector to help feed the inner wire. Note that the outer wire may wrinkle.
6. Look into the sight hole on top of the connector to ensure the inner wire has reached the tip.
7. Tighten the set screw at the tip to secure the inner wire.
8. Pull the cable slightly downward to smooth any outer wire wrinkles.
9. Once height is set, fully tighten the set screw on the conical connector.

### III. Installing the Fixture

#### Installing the FreeJack Connector onto MonoRail

OR

#### Installing the FreeJack Port with Canopy

- |  |  |
|--|--|
| <ol style="list-style-type: none"> <li>1. Place the FreeJack housing onto the top side of the MonoRail.</li> <li>2. From the underside of the MonoRail, tighten the FreeJack male conical connector into the housing.</li> <li>3. Ensure the insulating washer is correctly positioned, if required.</li> <li>4. Insert the bi-pin bulb into the socket and power the fixture on to test functionality.</li> </ol> | <ol style="list-style-type: none"> <li>1. Insert the fixture's FreeJack male conical connector into the FreeJack housing connector.</li> <li>2. Push and screw in the connector until fully seated and secure.</li> <li>3. Insert the bi-pin bulb into the socket and power the fixture on to test its functionality.</li> </ol> |
|--|--|