

MAYBECK 18 WALL SCONCE

AKOWS620WD

General Product Information

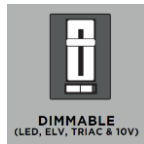
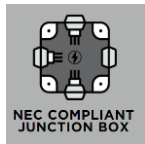
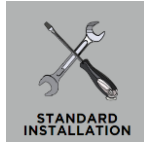
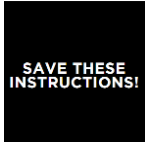

Product Warranty



FCC Statement

Suggested/Required Tools



Safety Information

CAUTION-RISK OF FIRE

This product must be installed in accordance with the applicable installation code by a person familiar with the construction and operation of the product and the hazards involved.

USE MINIMUM 90°C SUPPLY CONDUCTORS.



Turn off electrical current at the source before working with any lighting fixture or portable lamp.

Install and use this product in adherence with local electrical codes and regulations.



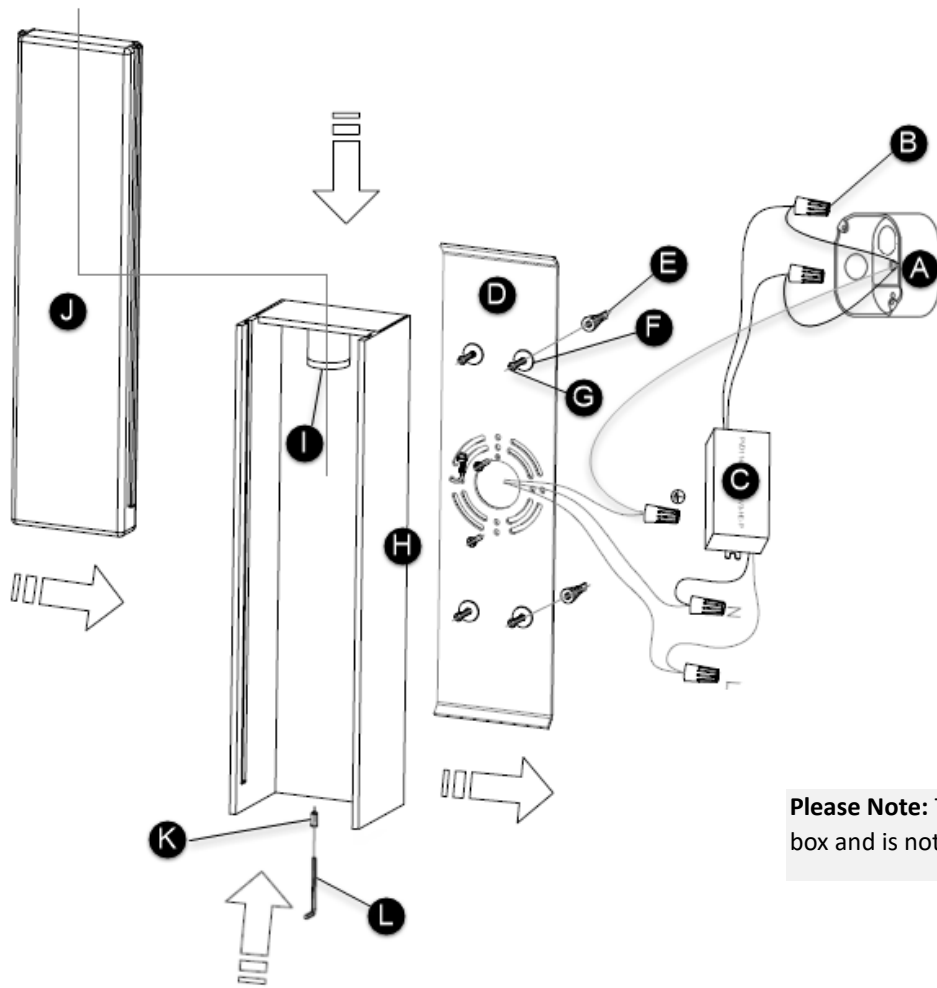

FIXTURE PARTS

- A. Junction box
- B. Wire Nut Connections
- C. Driver
- D. Mounting Plate
- E. Anchors
- F. Washers
- G. Anchor Screws
- H. Fixture Backplate/Base
- I. LED
- J. Glass Shade Panel
- K. Set Screw
- L. Allen Wrench

Please Note: This fixture uses a full-size junction box and is not compatible with pancake boxes.

INSTRUCTIONS

I. Preparing for Installation

1. Unbox and examine all items included in the fixture's packaging.
2. Separate the mounting plate from the fixture's backplate by removing the screws securing the fixture.
3. Use the mounting plate to trace and mark the locations for the anchors. Drill a hole at the marked locations to fit the anchors.

II. Wiring & Installing the Fixture

1. Safety first! Locate the circuit breaker and switch it off to disconnect power from the relevant circuits, ensuring there is no electricity running through the wiring.
2. Connect the LED driver input wires to the local power line wires. Twist the bare ends of the following pairs of wires together using a wire nut to secure the connection:
 - a) Neutral driver wire (white) to neutral power line wire
 - b) Hot driver wire (black) to hot power line wire
3. Place the driver in the junction box, ensuring the output driver wires are accessible.
4. Secure the mounting plate to the junction box using the anchor screws. Slide the washers onto the anchor screws and tighten them into the anchors, securing the mounting plate to both the junction box and the wall behind it.
5. In accordance with local electrical codes, connect the fixture ground wire (bare copper or silver wire) to a suitable ground. This may be a green ground screw on the mounting plate, around which the ground wire should be tightly wrapped, or a house wire (green or bare copper wire without insulation).
6. Now, twist the bare ends of the following pairs of wires together using a wire nut to secure the connection:
 - a) Negative/blue (-) fixture wire to negative/black (-) output driver wire
 - b) Positive/red (+) fixture wire to positive/red (+) output driver wire
8. Carefully tuck all the wires behind the mounting plate into the junction box.
9. Place the fixture backplate/base onto the mounting plate and secure it in place by installing the set screw.
10. Slide the glass shade panel into the slots provided on both sides of the fixture.
11. For wet locations, caulk around the fixture base with a waterproof construction sealant to complete installation.