

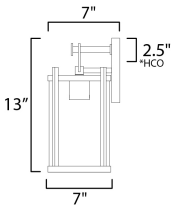

PRODUCT DESCRIPTION

Squared columns in Matte Black finish tower above the cylindrical glass shade rated for outdoor applications. A rectangular hook detail carries the square form through to the backplate. A modern interpretation of a bell tower, these outdoor pendants and sconces are a cleaned up, transitional look for exteriors.



MEASUREMENTS

DIMENSION : 7" W x 13" H x 7" Ext  
BACK PLATE : 4.75" W x 6.25" H x 2.5" HCO  
HANGING WEIGHT : 3.96 lb

LAMPING

INPUT VOLTAGE : 120V  
BULB : 1 x 60W Incandescent E26 Medium , 60W Total  
BULB INCLUDED : (Not Included)  
DIMMABLE : Y  
LIGHTING\_DIRECTION : Down

FINISHES OPTION

Black

GLASS

Clear CL

MATERIAL

Aluminum, Glass

RATINGS

cETLus  
Wet Location



ADDITIONAL

INSTALL UP/DOWN: Down  
RATED LIFE 2500 Hours  
OPERATING TEMPERATURE:  
-20°C (-4°F), 40°C (104°F)

Always consult a qualified electrician before installing any lighting product.



**WESTERN DISTRIBUTION CENTER (HEADQUARTER)**  
253 NORTH VINELAND AVE | CITY OF INDUSTRY, GA 91746  
**EASTERN DISTRIBUTION CENTER**  
4200 SHIRLEY DR. | ATLANTA, GA 30336  
P. 626.956.4200 | F. 626.956.4225 | maximlighting.com