

UL SPECIFICATION

- \* FIXTURE SHALL BE LISTED FOR LOCATION ONLY AND LABELED AS SUCH.
- \* FIXTURE MUST BE MANUFACTURED IN ACCORDANCE WITH UL STANDARD 1598.

PARTS SPECIFICATIONS  
ITEM QTY DESCRIPTION

- A

(1)

SOCKET- UL LISTED/CSA CERTIFIED  
BASE= MEDIUM  
SOCKET= PORCELIN  
SEE LEAD WIRE FOR SOCKET WIRE SPEC.
- B

(1)

LEAD WIRE- 8"  
UL LISTED/CSA CERTIFIED, AWG #18  
105°C BLACK AND WHITE WIRE.
- (1)

GROUND WIRE- 8"

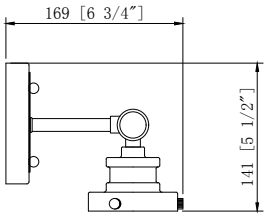
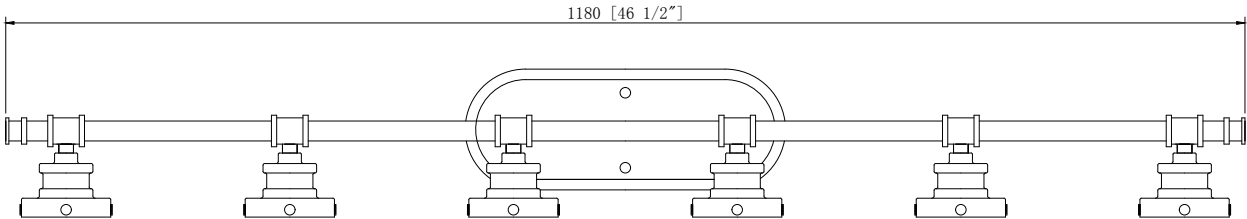

INNOVATIONS LIGHTING  
DESIGN COPYRIGHT - 29/07/2020  
ALL RIGHTS RESERVED AND MAY  
NOT BE DUPLICATED WITHOUT OUR  
WRITTEN PERMISSION

NO.	PART NO.	DESCRIPTION	REQ.

NOTICE: ANY DESIGN OR OTHER INFORMATION HEREON DEVELOPED BY THIS COMPANY IS CONFIDENTIAL MATERIAL AND EXCLUSIVE PROPERTY OF THE L.D. ALTA CO. DISCLOSURE OR REPRODUCTION REQUIRES THE WRITTEN CONSENT OF THE L.D. ALTA CO.

INNOVATIONS  
CREATIVITY MEETS EVOLUTIONARY DESIGN

TITLE	
6LT WALL MOUNT	
PART NO.	WALL
ITEM NO.	340-6W-BPN

DRAWN IN THIRD ANGLE PROJECTION	TOLERANCES (EXCEPT AS NOTED)			
	DECIMAL	ANGULAR	FRACTIONAL	SCALE
	NONE ±.031	± 1/2°	± 1/32	1:6
	X ±.015			
DATE		DRAWN BY	CHECKED BY	APPROVED BY
3/31/2021			X	X