

Family: Armognac | Item No. 4268 PL

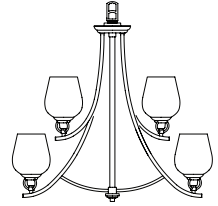

Drawing 1 - Fixture Assembly

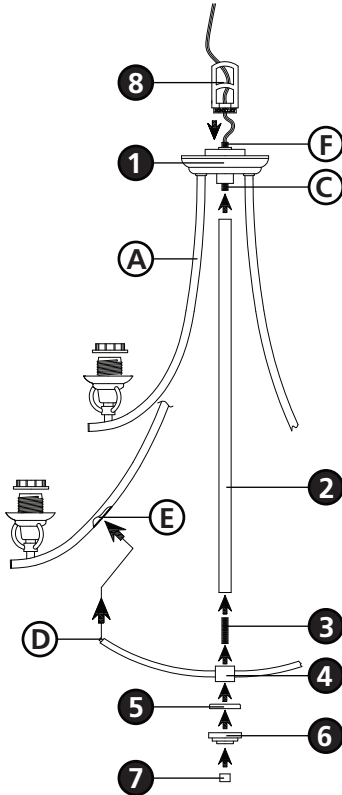

Drawing 2 - Glass Installation

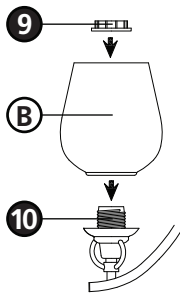

▼ start here

1

1. Find a clear area in which you can work.
2. Unpack fixture and glass from carton.
3. Carefully review instructions prior to assembly.

***** the construction of this fixture will be accomplished by first assembling the main body of the fixture, making all necessary electrical connections, hanging the fixture from the ceiling, and then installing the glass.**

SAFETY WARNING: READ WIRING AND GROUNDING INSTRUCTIONS (I.S. 18) AND ANY ADDITIONAL DIRECTIONS. TURN POWER SUPPLY OFF DURING INSTALLATION. IF NEW WIRING IS REQUIRED, CONSULT A QUALIFIED ELECTRICIAN OR LOCAL AUTHORITIES FOR CODE REQUIREMENTS.

2

1. Slip loop (8) along wire and thread onto nipple (F) located on the top of the main body assembly (1) - see **Drawing 1**.
2. Spread the top three arms (A) located on the main body assembly (1) until they are equally spaced 120 degrees apart.
3. Spread lower arms until they are equally spaced 60 degrees apart and are equally spaced between the top tier arms.
4. Thread center stem (2) onto nipple (C).
5. Thread nipple (3) into bottom of center stem (2).
6. Slip spider assembly (4) onto nipple (3).
7. Line up the pins (D) on the spider assembly (4) with the holes (E) located on the top three arms (A).
8. Slip cap (5) onto nipple (3) below spider assembly (4).
9. Slip bottom cap (6) onto nipple (3) making sure cap (5) sets inside of cap (6).
10. Thread finial (7) onto nipple (3) to secure assembly.
11. Please refer to the hanging instruction sheet (I.S. 19) provided to continue installation of this fixture. Then refer back to this sheet to install glass.

3

1. To install glass, remove socket ring (9) from socket (10) - see **Drawing 2**.
2. Slip glass (B) over socket (10).
3. Now thread socket ring (9) back on to socket (10) and tighten to secure glass (B).
Note: **DO NOT** use any tool to tighten socket ring (9). Over tightening may cause glass damage.
4. Fixture can now be lamped accordingly.

Note: Maximum wattage for 4268 fixture is 75 watts per bulb.

2.7.08