

Traverse Lotus Round 5" & 7"

14825RD, 14827RD | 1.0

GENERATION LIGHTING

GENERAL PRODUCT INFORMATION:

These fixtures are intended to be installed utilizing NEC compliant junction boxes.

This product is safety listed for wet locations.

This instruction shows a typical installation.

CAUTION - RISK OF FIRE

This product must be installed in accordance with the applicable installation code by a person familiar with the construction and operation of the product and the hazards involved.

Use minimum 90°C supply conductors.

SAVE THESE INSTRUCTIONS!

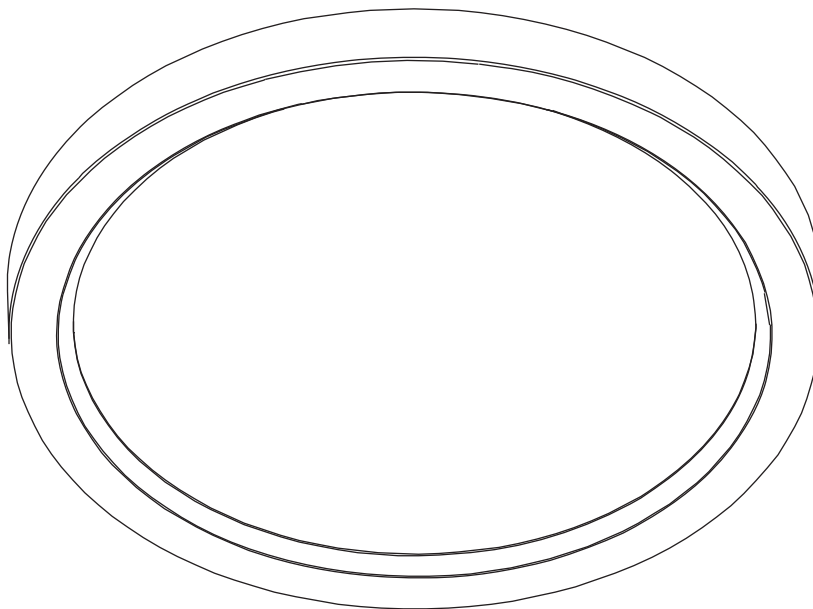

Install the Fixture

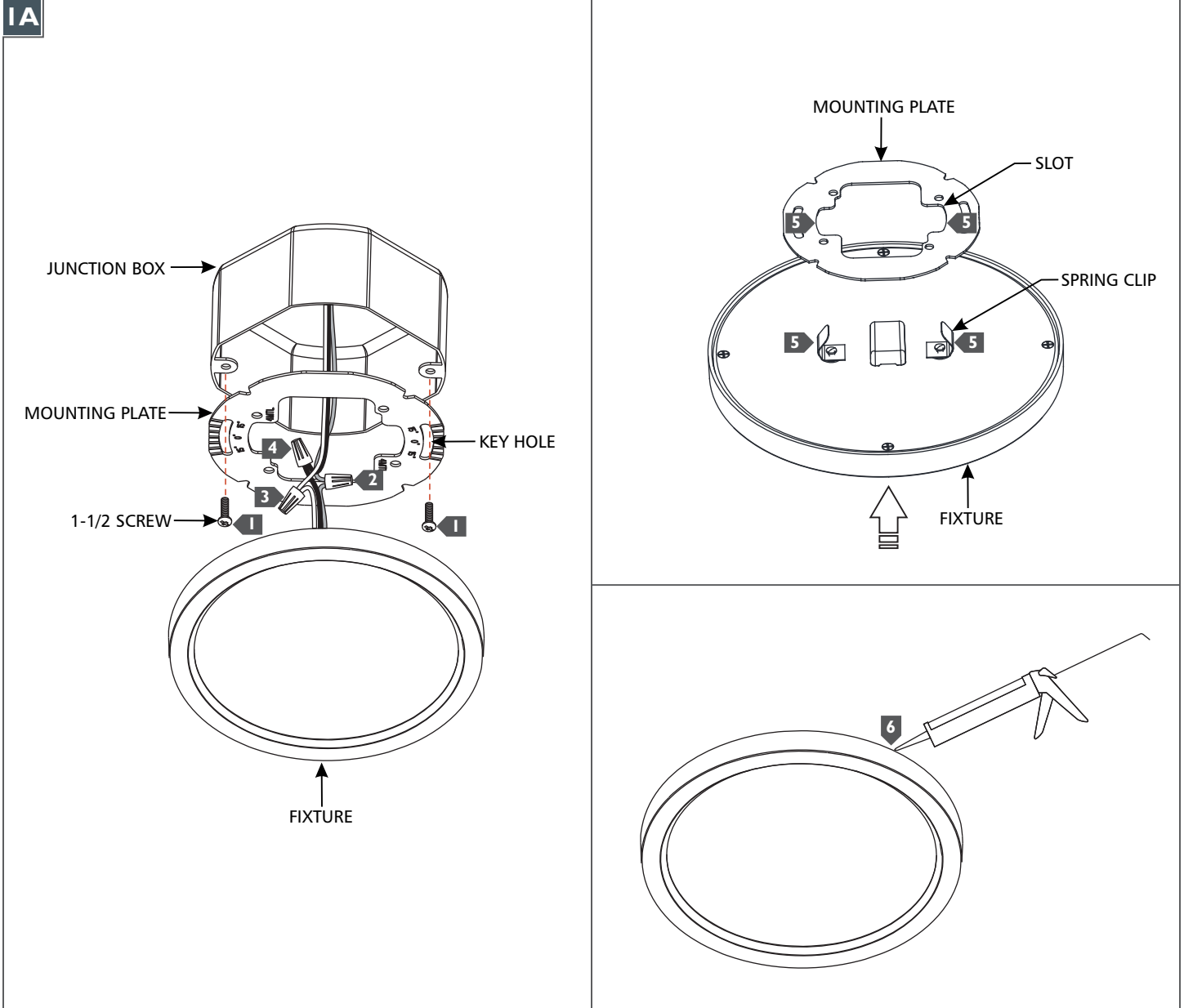

- 1** Align and secure the mounting plate to the junction box with the provided 1-1/2 screws.
- 2** Connect the fixture to a suitable ground in accordance with local electrical codes.
- 3** Connect the white fixture wire (square and/or rigid) to the neutral power line wire with a wire nut.
- 4** Connect the black fixture wire (round and/or smooth) to the hot power line wire with a wire nut.
- 5** Align the spring clips on the fixture to the slots on the mounting plate, carefully place all wires and wire nut connections into the junction box, then push up the fixture to lock it in place.
- 6** For wet locations, caulk around the fixture base with waterproof construction sealant.