

CORBETT

KRAKOW 509-22 Installation Instructions

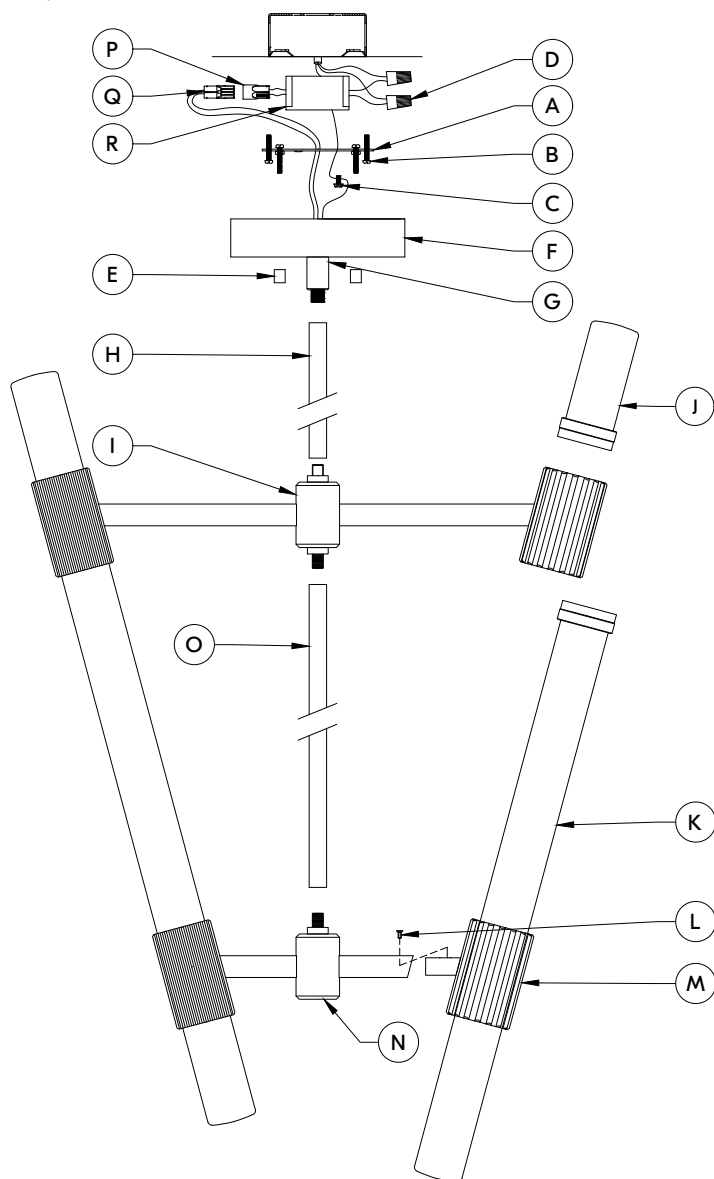

FIXTURE INSTALLATION

1. Feed the wire through the STEM KIT (H) and twist tightly onto the FIXTURE ASSEMBLY A (I). Keep adding additional stems until you desired hanging height is met.
2. Slide in CANOPY (F) onto the STEM KIT (H), and thread the CONNECTOR (G) onto the top end of the STEM KIT (H).
3. Attach the Ground wire (Green) to the ground inside the outlet box (Generally green or bar copper wire) or the GROUND SCREW (C) on the MOUNTING PLATE (A). NEVER CONNECT GROUND WIRE TO "HOT" WIRE! FAILURE TO FOLLOW THIS COULD RESULT IN SERIOUS INJURY OR DEATH!
4. Connect the white wire on the DRIVER (R) to the neutral (Generally white) wire in the outlet box. Fasten the wires together with an approved fastener (WIRE NUT) (D). Starting 1" below the fastener, tightly wrap the connection with electrical tape so that the connections seals the end of the fastener. MAKE SURE THERE ARE NO EXPOSED WIRE OF STRANDS THAT COULD CAUSE A DANGEROUS SHORT CIRCUIT!
5. Connect the black wire on the DRIVER (R) to the hot (Generally black) wire in the junction box. Fasten the joined wires same as previous step. NEVER REVERSE HOT AND NEUTRAL WIRES. FAILURE TO FOLLOW THIS COULD RESULT IN SERIOUS INJURY OR DEATH!
6. Roll up any remaining wire and DRIVER (R) inside the junction box. Install the MOUNTING PLATE (A) onto the junction box using the MOUNTING SCREWS (B). This fixture is designed to be mounted on standard round or octagon junction box. The junction box must be securely mounted to the structure of the building.
7. Insert the FEMALE (P) into the MALE (Q).
8. Push the wires back into the junction box. Lift up the CANOPY (F) up to the ceiling, and secure with the CAP NUTS (E).
9. Fasten the FITTING (M) to the FIXTURE ASSEMBLY B (N) with SCREWS (L), and then connect to the FIXTURE ASSEMBLY A (I) using the ROD (O).
10. Put the LED ASSEMBLY B (K) into the FITTING (M). Screw the LED ASSEMBLY A,B (J,K) to the FIXTURE ASSEMBLY B (N) of the fixture.
11. Restore power to the outlet at the breaker or fuse box.

| PART(S) | REPLACEMENT PART NAME | NUMBER | PART(S) | REPLACEMENT PART NAME | NUMBER |
|---------|-----------------------|----------------|---------|-----------------------|--------------|
| A,B,C,D | HARDWARE KIT | HDW-509-22 | K | LED ASSEMBLY B | LAS-509-22-B |
| E | CAP NUT | CPN-509-22 | L | SCREW | SCR-509-22 |
| F,G | CANOPY ASSEMBLY | CAS-509-22 | O | ROD | ROD-509-22 |
| H | STEM KIT | STM-LTI600-KIT | R | DRIVER | DVR-509-22 |
| J | LED ASSEMBLY A | LAS-509-22-A | | | |