

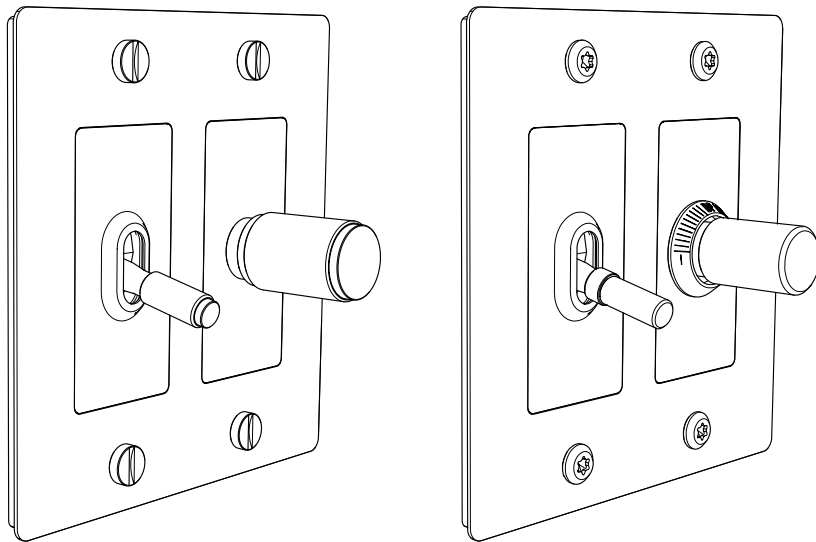

US ELECTRICITY

CROSS / LINEAR DETAILS KIT

INSTRUCTION MANUAL US
MANUEL D'UTILISATION É.-U.
MANUAL DE INSTRUCCIONES (EE. UU.)



US.BUSTERANDPUNCH.COM
L0260

For wiring and plate installation, refer to module instruction manual.

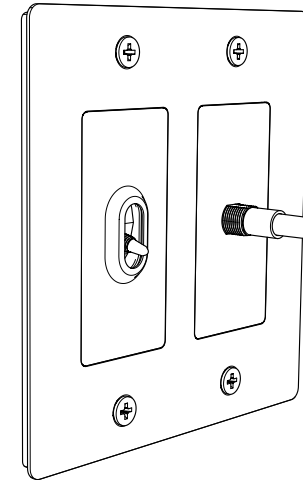

NOTE:

For removal, follow steps in reverse.

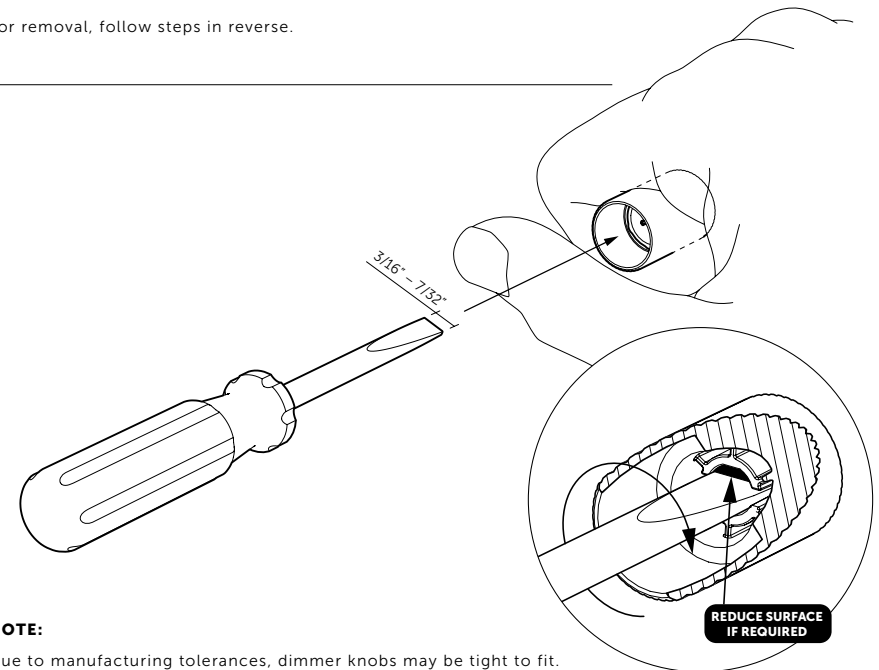

NOTE:

Due to manufacturing tolerances, dimmer knobs may be tight to fit.

To allow for easier assembly, insert a 3/16" – 7/32" (5 – 5.5mm) flat head screwdriver and rotate 360° to remove excess material from the flat section of the insert.

There will be some resistance (a little more than turning a key in a lock) and a small amount of material may come loose – this is normal.

Ensure screwdriver is held straight to avoid misalignment and off-center rotation when installed.

CROSS DETAILS:

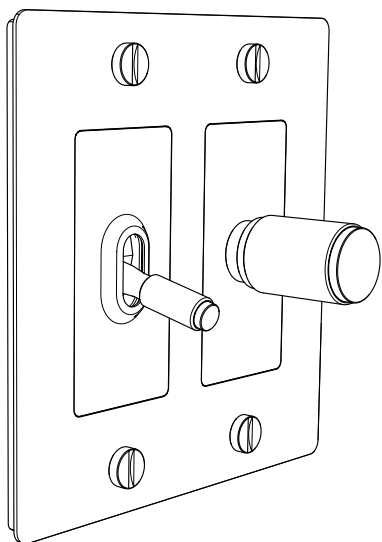
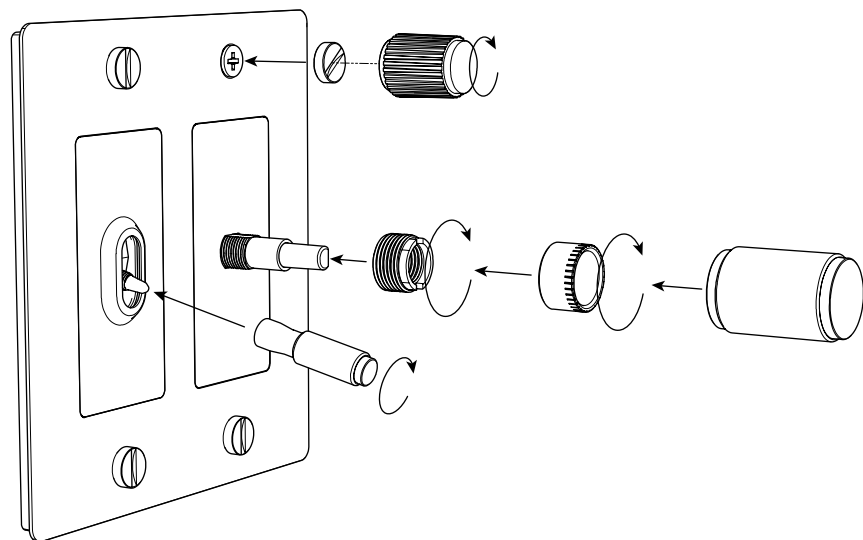

LINEAR DETAILS:

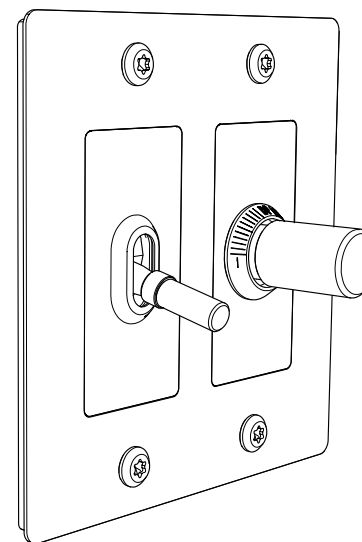
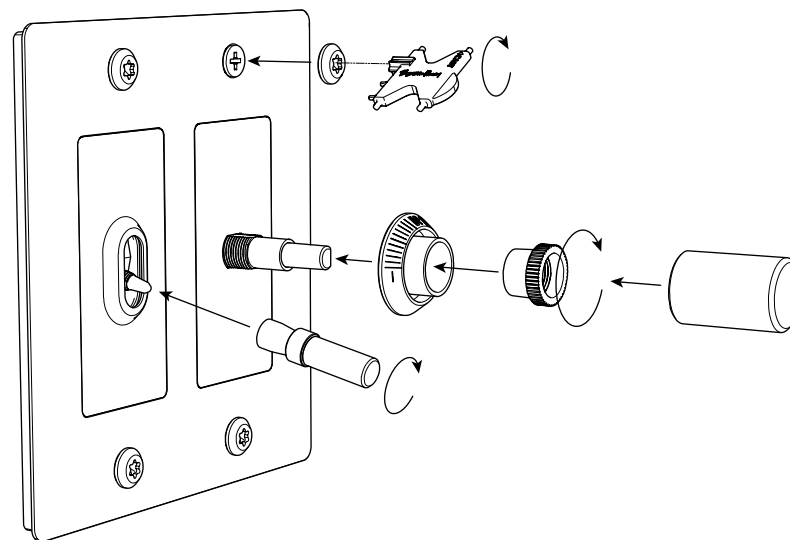

[end. **ORDINARY**]