

ASSEMBLY INSTRUCTIONS

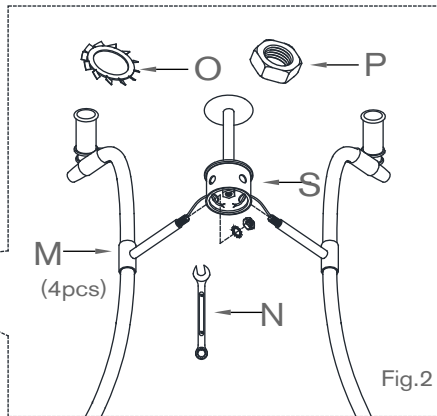
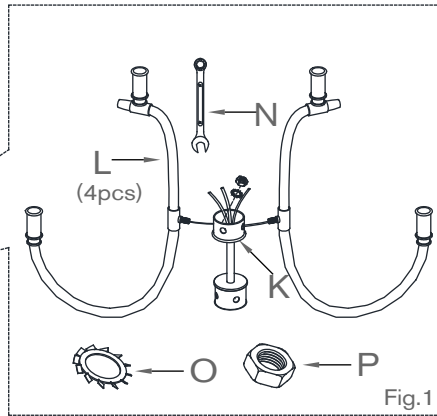
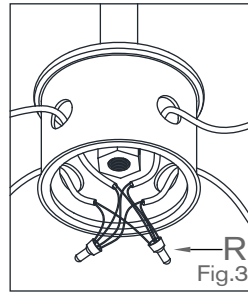
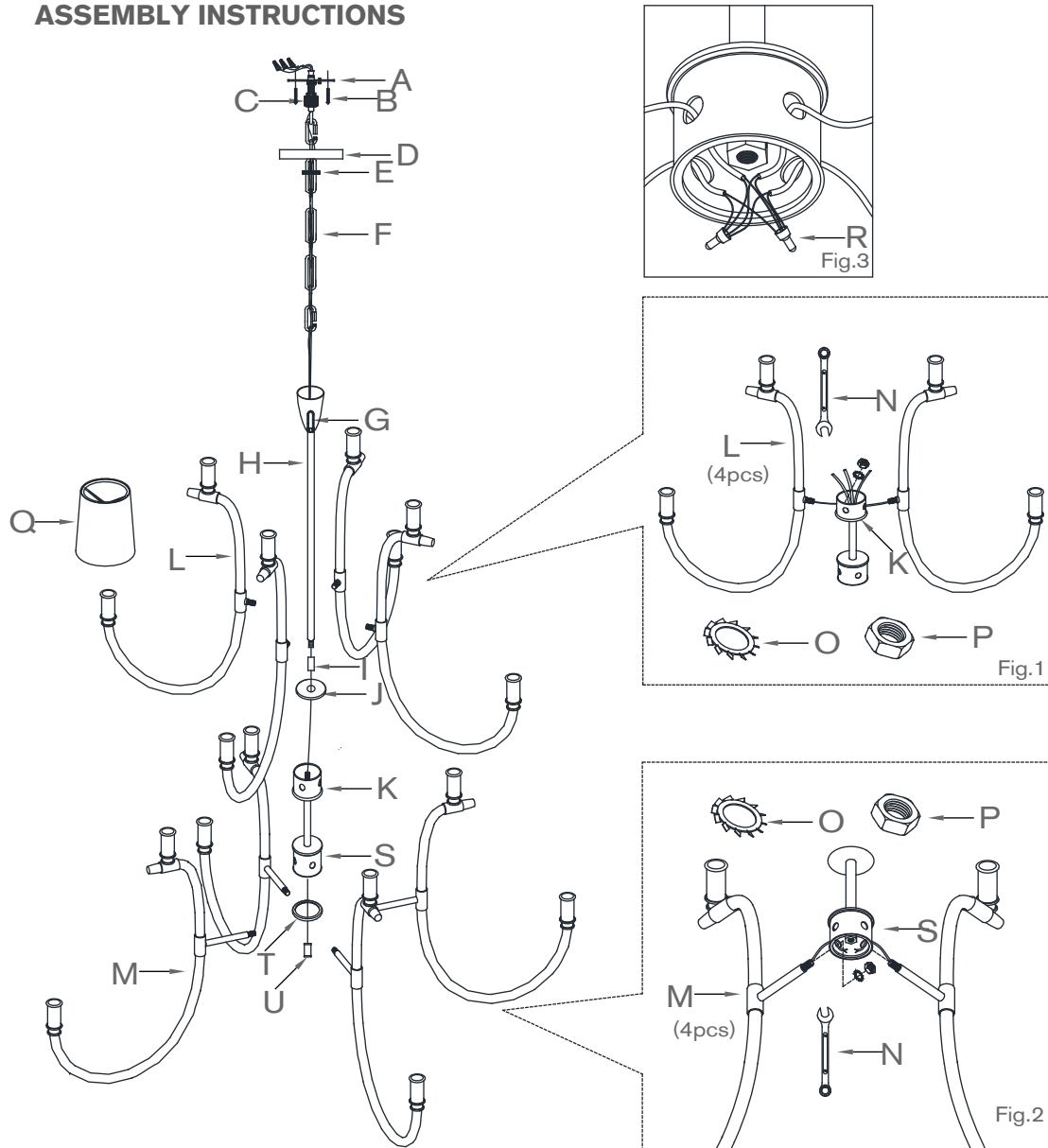

Clarice Large Chandelier

Item # JN 5030

WE RECOMMEND INSTALLATION OF THIS LIGHTING FIXTURE BE DONE BY A LICENSED ELECTRICIAN.

WARNING * SWITCH OFF THE MAIN ELECTRICAL SUPPLY FROM THE MAIN FUSE BOX/CIRCUIT BREAKER BEFORE INSTALLATION.**

INSPECT ITEM CAREFULLY BEFORE ATTEMPTING TO INSTALL. IF THERE IS ANY DAMAGE OR OBVIOUS DEFECT, DO NOT INSTALL.

ITEM MAY NOT BE RETURNED ONCE IT HAS BEEN INSTALLED.

1. Carefully remove all parts from the carton.
2. Remove plate (J) from fixture body (K) by removing connector (I); remove cap (T) from fixture body (S) by removing finial (U).
3. Take off the hex nuts (P) and washers (O) from arms (L), insert the nipple of arm (L) into the hole fixture body (K) and secure with spring washer (O) and nuts (P). Tighten with wrench (N). (Refer to Fig.1)
4. Take off the hex nuts (P) and washers (O) from arms (M), insert the nipple of arm (M) into the hole fixture body (S) and secure with spring washer (O) and nuts (P). Tighten with wrench (N). (Refer to Fig.2)
5. Connect the hot wire (smooth edge, with markings outside) from the arms to the jumper wire (smooth edge, with markings outside) and the main wire (smooth edge, with markings outside) using a wire nut (R). Cut the exceed wires with a wire cutter if needed. (Refer to Fig.3)
6. Connect the neutral wire (ribbed,no markings) from the arms to the jumper wire (ribbed, no markings) and the main wire (ribbed, no markings) and the main wire (ribbed,no markings) using a wire nut (R). Cut the exceed wires with a wire cutter if needed. (Refer to Fig.3)
7. Wrap all connections individually with electrical tape.
8. Replace plate (J) to fixture body (K) and secure with connector (I).
9. Replace cap (T) to the bottom of fixture body (S) and secure with finial (U).
10. Screw the bottom nipple of pole (H) into the connector (I) by turning in a clockwise direction.
11. Attach mounting strap (A) to ceiling outlet box and secure with mounting screws (B).
12. Unscrew canopy ring (E), slide canopy ring (E) and canopy (D) on chain (F).
13. Attach chain (F) to hanging loop (G) and mounting loop (C) by opening/closing end link of chain.
14. Feed wire through the chain (F), canopy ring (E), canopy (D) and mounting loop (C).
15. Attach the bare copper ground wire from the fixture to the ground junction box wire (usually green or copper), fasten together with a plastic wire connector. Tightly wrap the wire connector with electrical tape. Be sure no wire strands are exposed. **IT IS IMPERATIVE THAT THE OUTLET BOX IN YOUR HOME BE PROPERLY GROUNDED.**
16. Connect neutral wire from fixture (ribbed molded wire) to the neutral wire from the junction box (usually white). Fasten both wires together with a plastic wire connector and tightly wrap the wire connector with electrical tape. Be sure no wire strands are exposed.
17. Connect the hot wire from the fixture (smooth wire) to the hot wire (usually black) from the junction box. Fasten both together with a plastic wire connector and wrap the connection with electrical tape. **DO NOT REVERSE THE HOT AND NEUTRAL CONNECTIONS OTHERWISE SAFETY WILL BE COMPROMISED.**
18. Tuck the wire connections neatly into the ceiling outlet box.
19. Slip canopy (D) to mounting strap (A) and secure with canopy ring (E).
20. Insert light bulbs (not included) into sockets.
21. Clip shades (Q) onto the light bulbs.
22. Restore power and test fixture. Installation is complete.

*** Clean with a dry, soft cloth only. Use no harsh abrasives or chemical agents.