

# TEAR SHEET

## Fresno Medium 2-Light 3/4 Wall Lantern

Item # CHO 2935AI-CG

Designer: Chapman & Myers

Height: 16"

Width: 10"

Extension: 5.75"

Backplate: 9.5" x 15.5" Rectangle

Finishes: AI

Glass Options: CG

Socket: 2 - E26 Keyless

Wattage: 2 - 8 LED T10

Weight: 12 Pounds

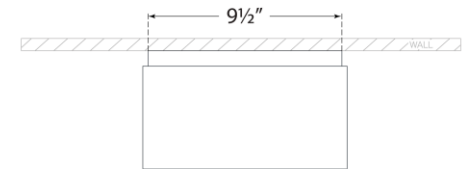

Top View

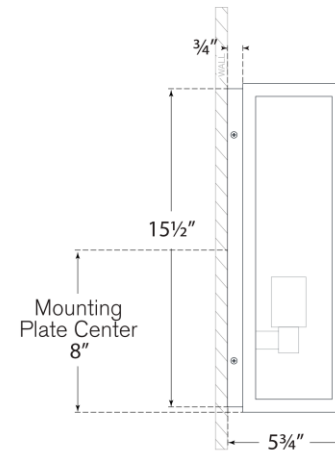

Side View

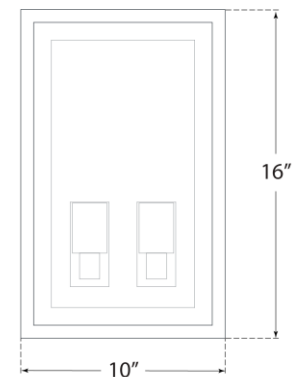

Front View