

SkyPlug Pre-Lit Tree INSTALLATION MANUAL



For Models:

#3208/#3209 - 3ft Upward Facing Chandelier Tree

#3210-3ft Downward Facing Chandelier Tree

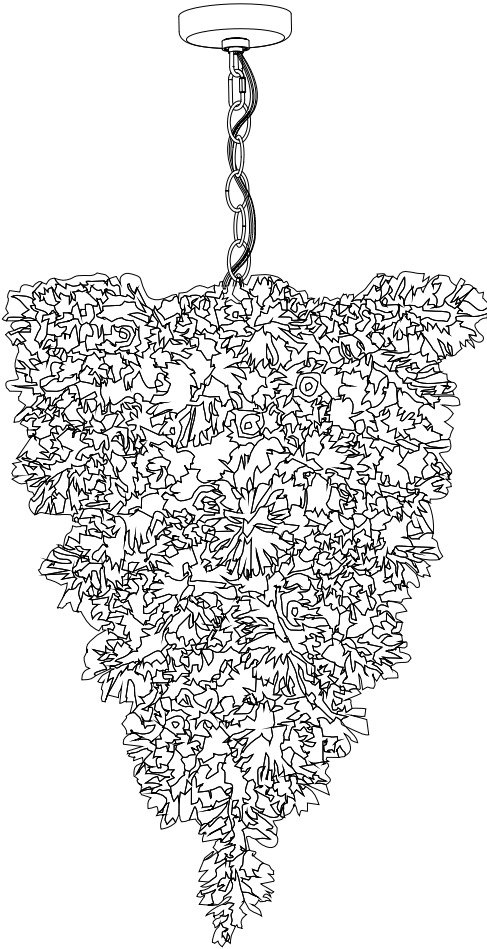

*View Instructional Video
before beginning*



IMPORTANT SAFETY INSTRUCTIONS

BASIC PRECAUTIONS SHOULD BE FOLLOWED WHEN USING THIS PRODUCT: (Inspect product carefully before using or re-using):

1. The product is for indoor use only.
2. Do not use this product for other than its intended use.
3. Do not hang ornaments or other objects from cord, wire, or light string.
4. Do not cover the product with a cloth, paper or any material not part of the product when in use.
5. Do not mount or place near gas or electric heaters, fireplaces, candles or other similar sources of heat.
6. To reduce the risk of fire, do not deliberately reposition either bulb or lamp holder contact.
7. Shut off the power when leaving the house, when retiring for the night, or if left unattended.
8. This is an electrical product -not a toy! To avoid the risk of fire, burns, personal injury, and electric shock it should not be played with or placed where small children can reach it.
9. This seasonal use product is not intended for permanent installation or use.
10. This product is equipped with push-in type lamps. Do not twist lamps.
11. This product employs overload protection (fuse). A blown fuse indicates an overload or short-circuit situation. If the fuse blows, unplug the product from the outlet. Replace the fuse as per the instructions (follow product marking for proper fuse rating) and check the product. If the replacement fuse blows, a short-circuit may be present and the product should be discarded.

BULB REPLACEMENT:

1. Shut off the power source.
2. Hold the socket, pull bulb AND plastic base straight out of socket. Do not twist bulbs.
3. Replace burned bulb with 2.5 volt 0.425 watt bulb ONLY.

CAUTION: Always shut off the power source before either fuse or bulb replacement.



FUSE REPLACEMENT:

1. Shut off the power source .
2. Locate blown fuse(s) by sliding access cover on top of plug towards prongs using a flathead screwdriver.
3. Remove blown fuse by turning the plug over. Fuses should fall into your hand (Gentle tapping may be required).
4. Insert new fuse. Close fuse cover by sliding fuse access cover towards the cord.

CAUTION: To reduce risk of fire – replace fuse in tree stand plug with only 3-amp 125 volt fuse .Do not replace attachment plug. Discard product if the attachment plug is damaged.

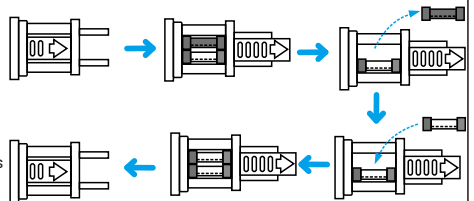

STORAGE:

When storing the product, carefully remove the product from wherever it is placed, including trees, branches, to avoid any undue strain or stress on the product conductors, connections, and wires. Disassembled tree can be stored in its original box. Store tree in a cool dry place where the temperature does not exceed 100 degrees Fahrenheit.

Pre-assembled Parts

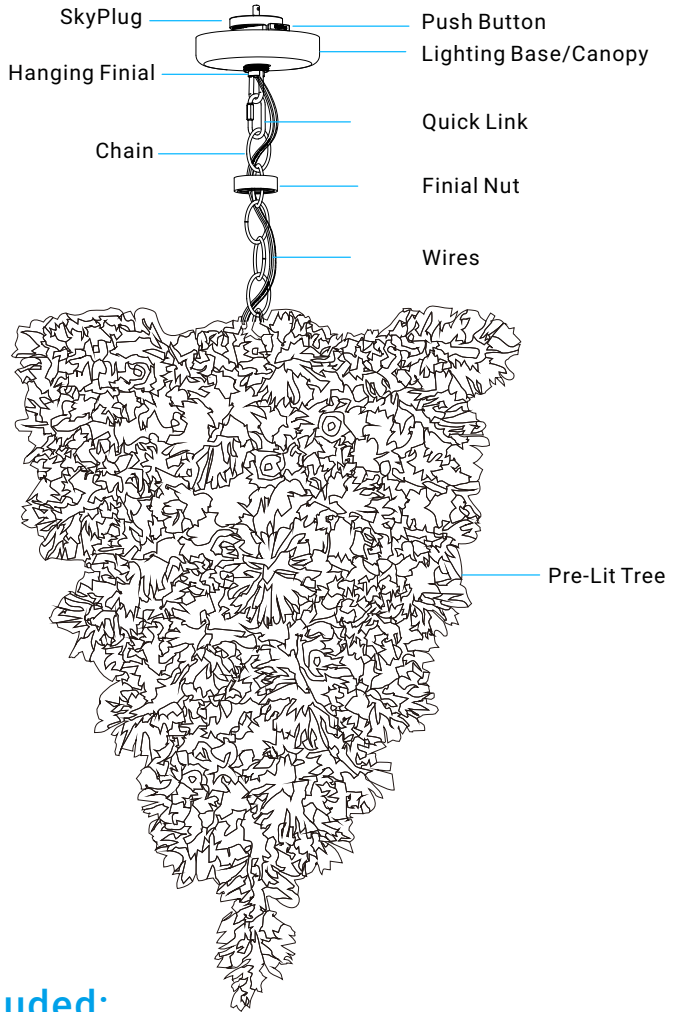

Parts Included:

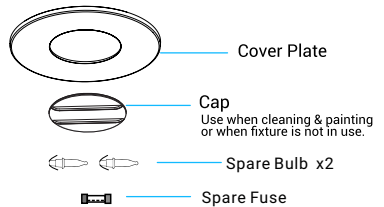
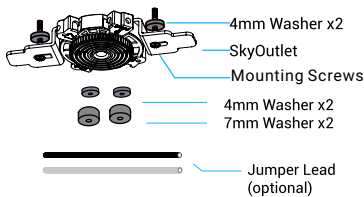

IMPORTANT SAFETY INFORMATION

1. Disconnect power by turning off the circuit breaker or by removing the fuse at the fuse box. (All electrical steps should be performed by a qualified person or electrician.)
2. Ensure wiring and outlet box are compliant with national and local electrical codes, including the NEC. SkyOutlet requires installation on the branch circuit (Solid 12 or 14 AWG wire) and should be installed by a qualified person or electrician.

Prepare for SkyOutlet Installation

Push the middle of SkyOutlet to separate cover plate and SkyOutlet

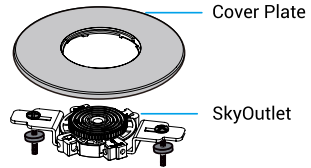
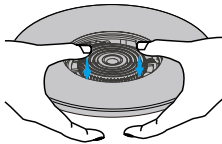

SkyOutlet Wiring and Installation

IMPORTANT: Disconnect power by turning off the circuit breaker or by removing the fuse at the box. All electrical steps should be performed by a qualified person or electrician.

1 Wire SkyOutlet to ceiling junction box.

1. Strip wire to 9/16"/14mm.

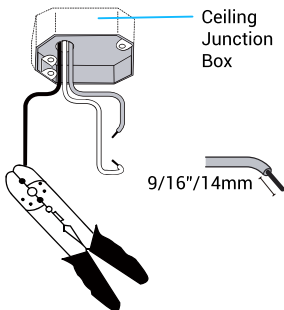

2. Loosen terminal screws to insert branch circuit wires into the corresponding terminals. Tighten to secure wires. Check to make sure wires are securely inserted into terminals. Set screw torque value at 6.3 lb/in.

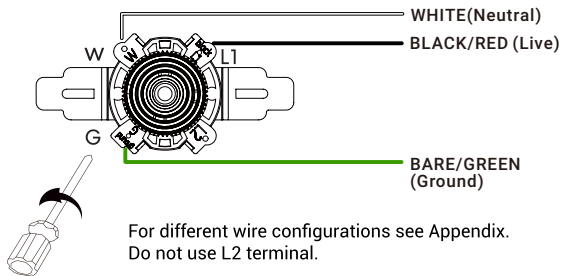

2 Secure SkyOutlet to outlet box using 2 screws and washers (included).

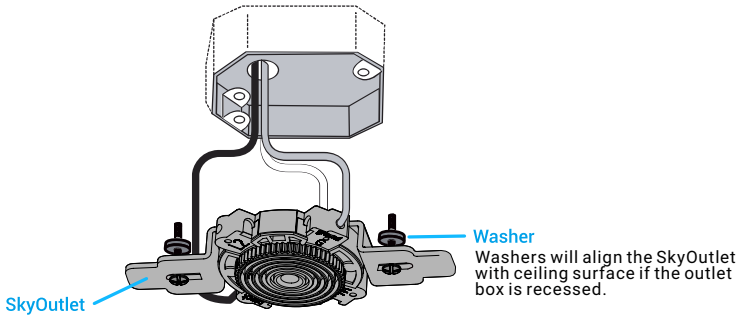

IMPORTANT: If your box is flush with ceiling or recessed less than 1.5 mm (0.06"), use 4 mm washer. If recessed between 1.5 mm (0.06") and 3 mm (0.12") use larger 7 mm rubber washer. If recessed more, use combination of both washers.

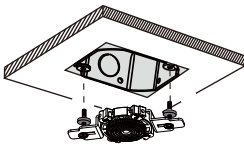

4mm rubber washer

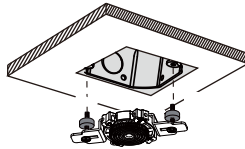

7mm rubber washer

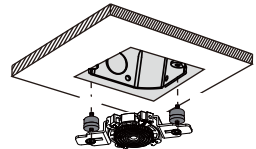

4mm rubber washer
7mm rubber washer

3 Secure cover plate as shown.

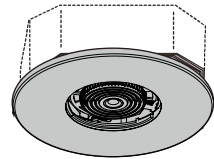
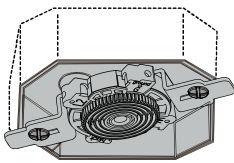

Align tabs on the cover plate with the SkyOutlet bracket and press to secure in place.

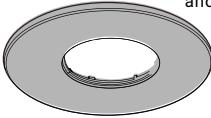

NOTE: A center cap is provided to cover and protect the SkyOutlet when the light fixture is removed for painting, maintenance, etc. To install the center cap, align the two slots on the cover plate and turn to secure.

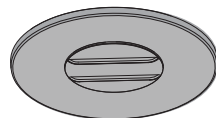
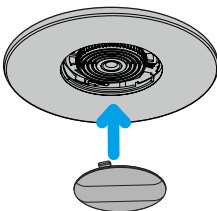

Installation of Fixture with SkyPlug

- 1 Loosen finial nut and allow canopy to drop down.

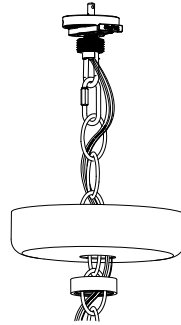

- 2 Hold the chain, plug into the SkyOutlet.

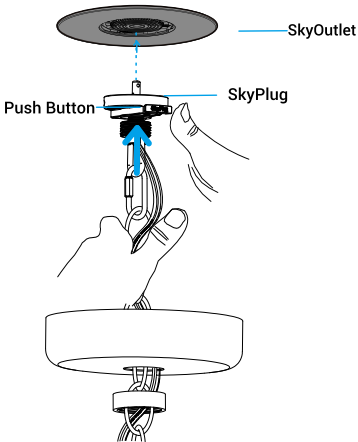

Align with the center hole, keep pressing the push button to insert into the SkyOutlet.

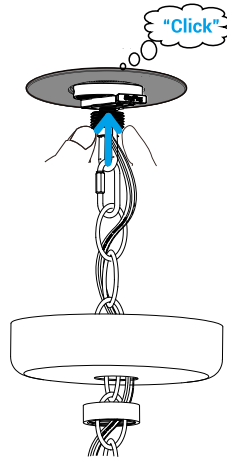

Once inserted, push up until you hear the "click" sound.

- 3 Once plugged in, slide the canopy up to the ceiling surface and secure in place with the finial nut.

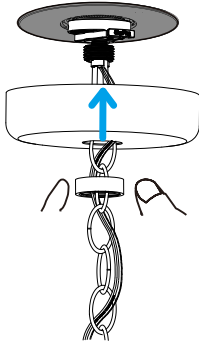

Removing SkyPlug Pre-Lit Tree.

- 1 Loosen finial nut and allow canopy to drop down.

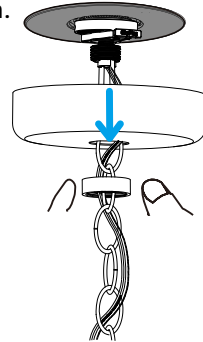

- 2 Release the fixture from ceiling.

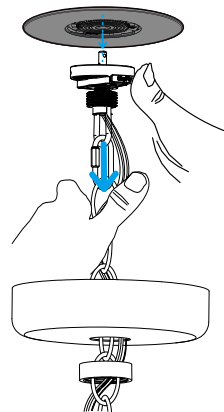
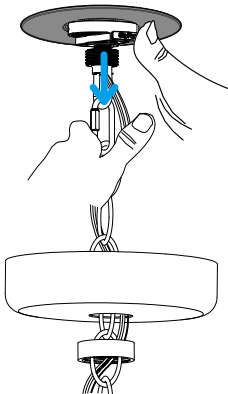

While holding the fixture securely, press the side push button.

Keep button pressed in and remove SkyPlug from SkyOutlet

Shaping the Tree Branches

Shape the branches from the inner tips outward on each branch. Starting with tips closest to the trunk - position one tip to the right, one to the left and one at the center of the main stem as illustrated.

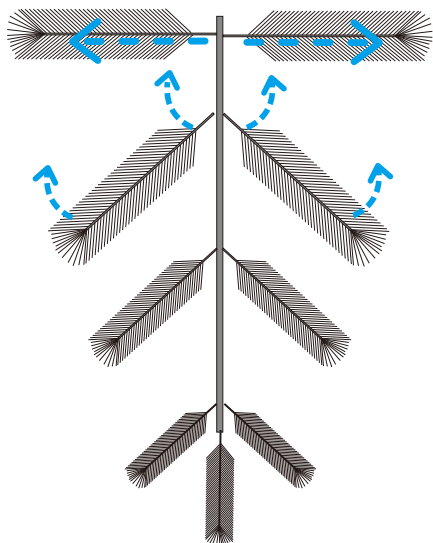

Shape the tips to fill gaps between branches to make the tree full and natural looking.

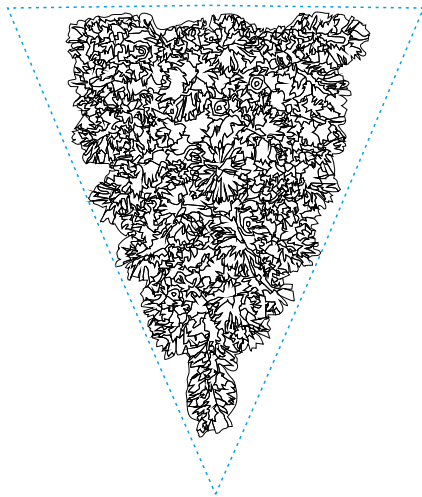

***The pre-lit SkyPlug Tree is now ready.
Switch on to light up!***

If you enjoyed your plug & play Chandelier Tree, you are now wired and ready to plug & play your light fixtures. Canopy Retrofit kits with the SkyPlug are available in 8 finishes to easily convert your light fixture to Plug & Play. Please go to SkyPlug.com to learn more!

APPENDIX

Additional Wiring Diagram

IMPORTANT: If you have multiple wires inside your outlet box, you will need to determine which lead is the live or switched lead and insert this lead into L1. If you are not sure how your house is wired, contact 1-866-885-4649 for questions or contact an electrician. When multiple wires are connected together use a solid wire 12 or 14 AWG JUMPER LEAD (included) to insert into the receptacle terminal. **Do not use L2.**

WIRING DIAGRAM #1:

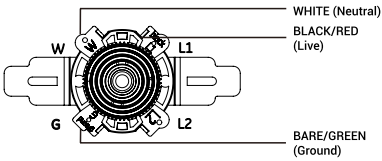

WIRING DIAGRAM #4:

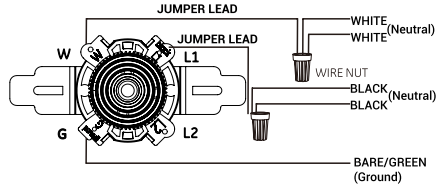

WIRING DIAGRAM #2:

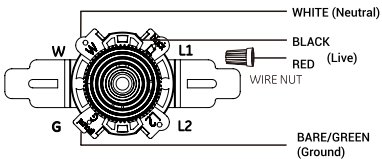

WIRING DIAGRAM #5:

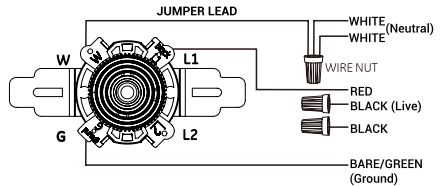

WIRING DIAGRAM #3:

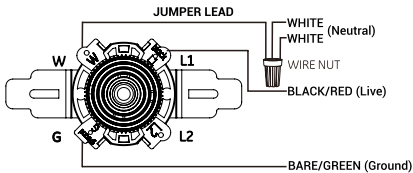

NOTE: If you have multiple wires connected together, add the included JUMPER LEAD and insert jumper lead into terminal. Only one single wire can be inserted into terminal (See diagram 3-5).

WARRANTY

LIMITED 1 YEAR WARRANTY

SKYX Platforms Corp. (SKYX), provides this limited warranty to the purchaser (Purchaser) of SKYX's SkyPlug Canopy Retrofit Kit (Product). This warranty is not assignable or transferable to any party.

This Product is warranted against any electronic or mechanical defects for a period of one (1) year from the date of original purchase (Warranty Period). SKYX will repair or, at its option, replace the defective Product or component parts without charge if, within the Warranty Period, the Product has been proven to be defective and is returned by Purchaser to SKYX with satisfactory proof of purchase. Any replacement or repaired Product or components will be warranted to the original Purchaser for the remaining portion of the Warranty Period. This warranty does not cover any Product (a) installed by any party other than SKYX; (b) that has been subject to neglect, accident, abuse, improper wiring, incorrect voltage or any other forms of misuse; (c) that has been used in a manner inconsistent with the warnings and instructions contained in the product documentation; (d) that appears to have been opened, disassembled or tampered with; or (e) purchased from a third-party. This warranty does not cover costs for removal or installation of the Product for repair.

EXCEPT FOR THE LIMITED WARRANTY SET FORTH ABOVE, SKYX EXPRESSLY DISCLAIMS ALL WARRANTIES WITH RESPECT TO THE PRODUCT, EITHER EXPRESS, IMPLIED OR STATUTORY, INCLUDING, BUT NOT LIMITED TO, THE IMPLIED WARRANTIES OF MERCHANTABILITY, FITNESS FOR A PARTICULAR PURPOSE, QUIET ENJOYMENT, TITLE AND NON-INFRINGEMENT.

To obtain warranty service, email support@skyplug.com.

LIMITATION OF LIABILITY

TO THE MAXIMUM EXTENT NOT PROHIBITED BY LAW, IN NO EVENT AND UNDER NO CIRCUMSTANCES SHALL SKYX BE LIABLE TO THE PURCHASER OF ITS PRODUCT OR ANY THIRD PARTY FOR ANY INCIDENTAL, SPECIAL, INDIRECT OR CONSEQUENTIAL DAMAGES WHATSOEVER, INCLUDING, WITHOUT LIMITATION, DAMAGES FOR LOSS OF PROFITS, LOSS OF DATA, LOSS OF GOODWILL, BUSINESS INTERRUPTION OR ANY OTHER DAMAGES OR LOSSES, ARISING OUT OF OR RELATED TO PURCHASER'S POSSESSION OR USE OF THE PRODUCT, HOWEVER CAUSED, REGARDLESS OF THE THEORY OF LIABILITY (WHETHER BY BREACH OF CONTRACT, WARRANTY, NEGLIGENCE, STRICT LIABILITY IN TORT, OR OTHERWISE) AND EVEN IF ADVISED OF THE POSSIBILITY OF SUCH DAMAGES. IN NO EVENT WILL SKYX'S TOTAL LIABILITY ARISING OUT OF OR RELATED TO THE PRODUCT, WHETHER ARISING OUT OF OR RELATED TO BREACH OF CONTRACT, TORT (INCLUDING NEGLIGENCE) OR OTHERWISE, EXCEED THE AMOUNT THE PURCHASER PAID FOR SUCH PRODUCT.