

HABSBURG
S9215- __ __ O

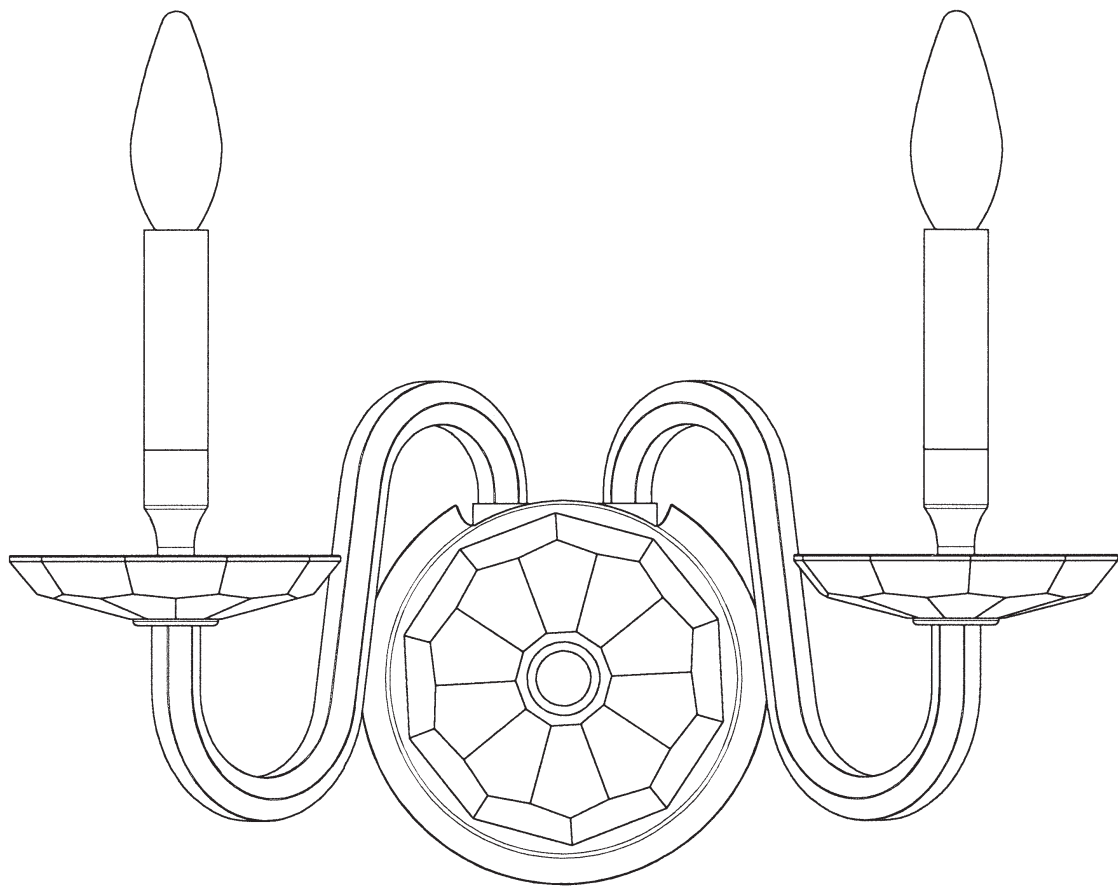

THIS DESIGN IS THE PROPRIETARY
TRADE DRESS/TRADEMARK OF
W SCHONBEK LLC.



			S					
MAX 60 W		110-120 V						

WARNING:

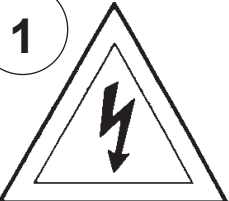
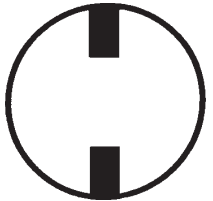
1  **Electrical Danger**  **Turn Power Off**

All electrical components must be installed by a licensed electrician in accordance with the National Electric Code and the appropriate local electrical codes.

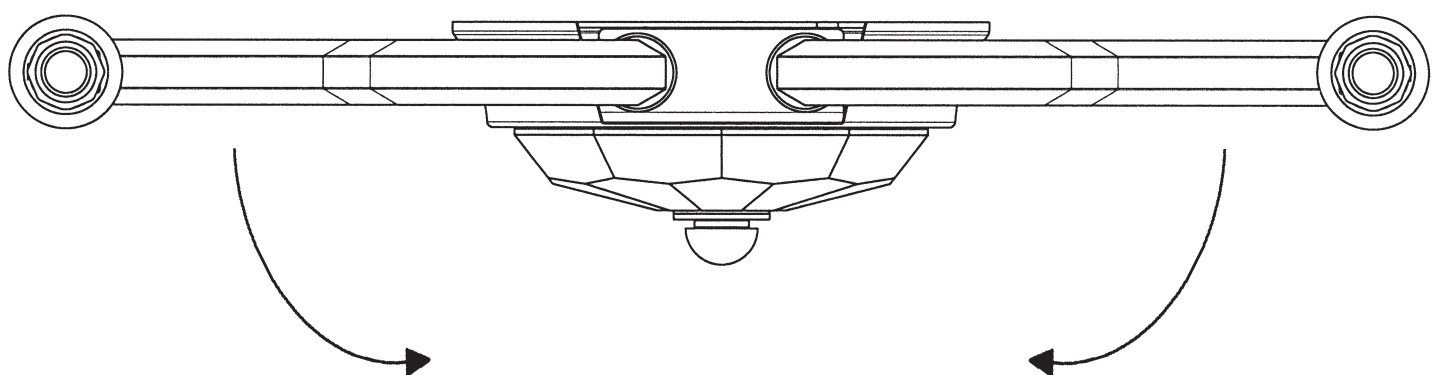
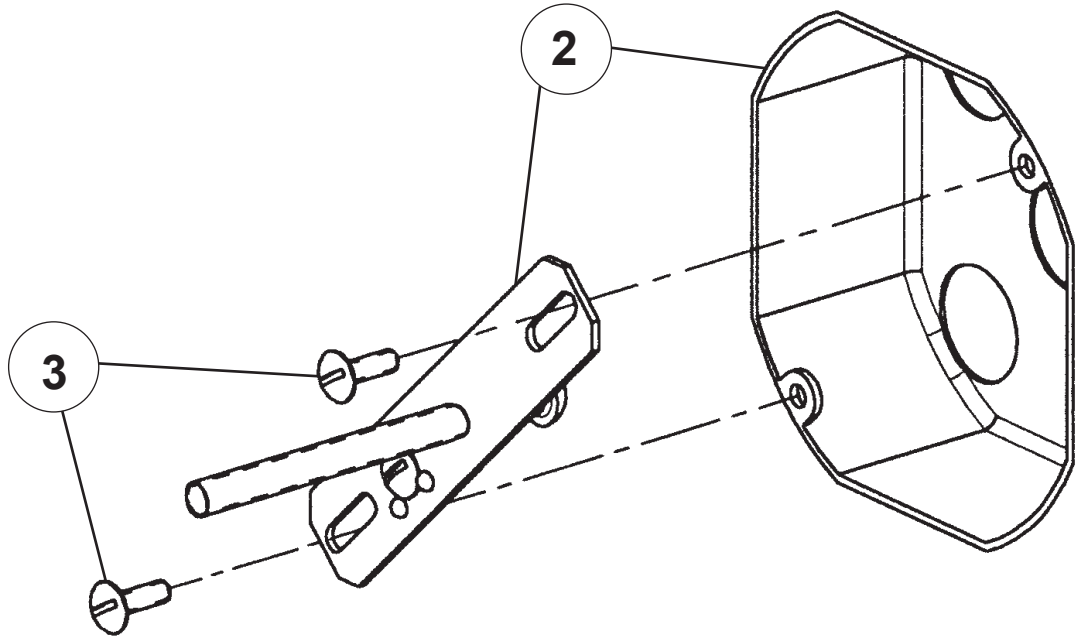

4 Turn arms to line up holes in arms with dimple in plate. Tighten lock washer and nut to secure arms in place.

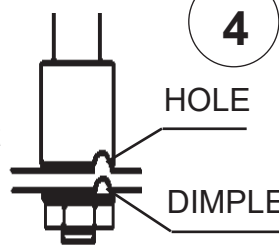

HOLE

DIMPLE

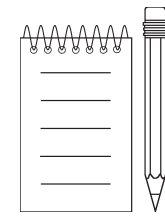

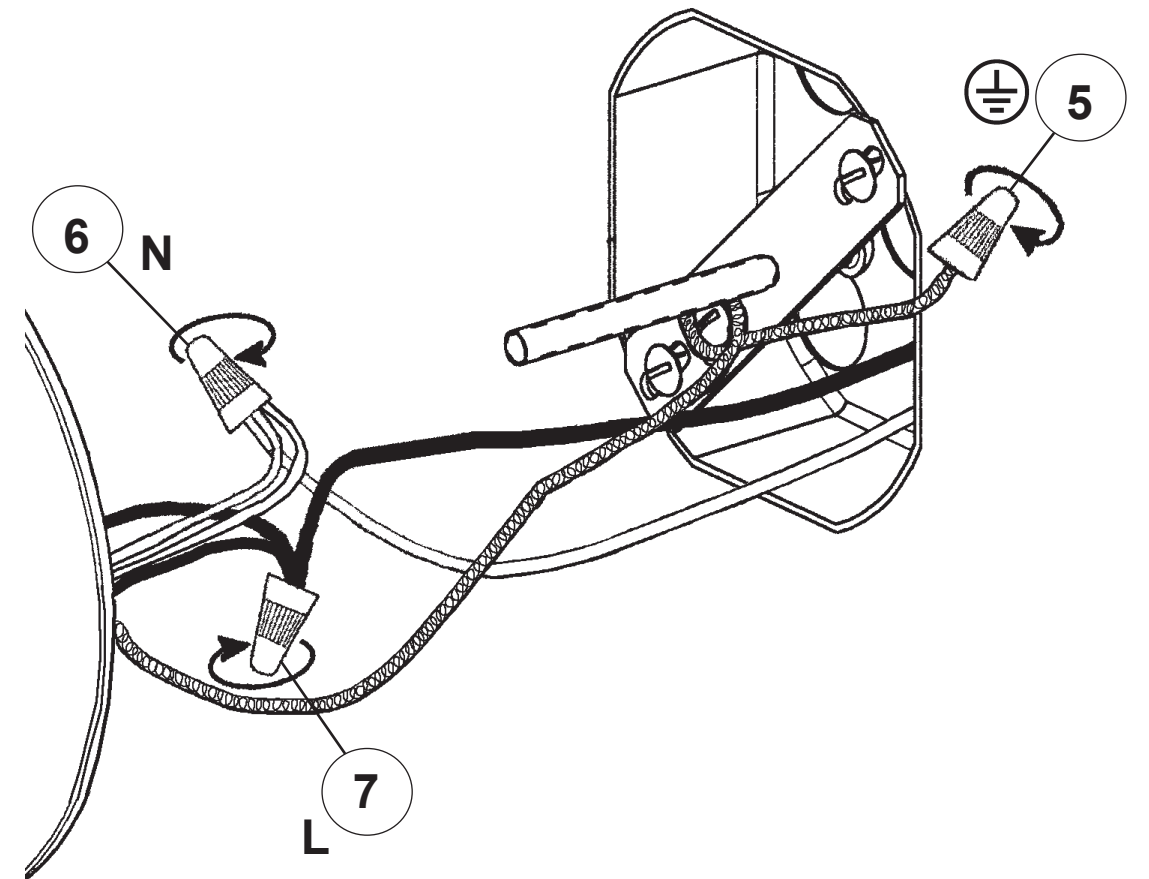

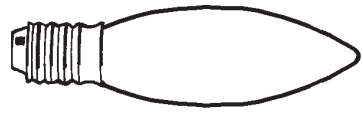

You will need 2 - B10
25 Watts Recommended
60 Watts Max

