

Tools Required

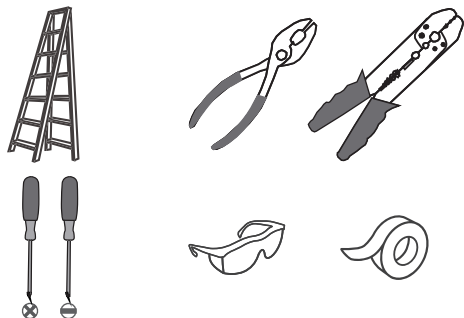

Light Source

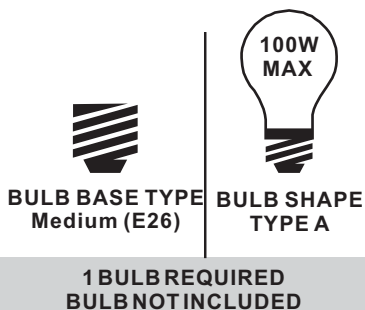

Warnings and Cautions

Turn off the electricity at the circuit breaker before installation. Consult a licensed electrician if in doubt about installation.

Turn off power to the fixture and allow the bulbs to cool before replacing.

Package Contents

Preparation: Identify and inspect all parts before beginning the installation.

Missing or damaged parts? Contact your original place of purchase.

PARTS BAG

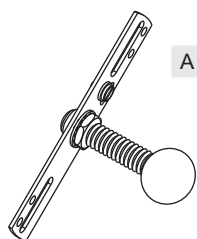

A Crossbar Assembly
x 1



B Outlet Box Screw
x 2



C Wire Connector
x 3

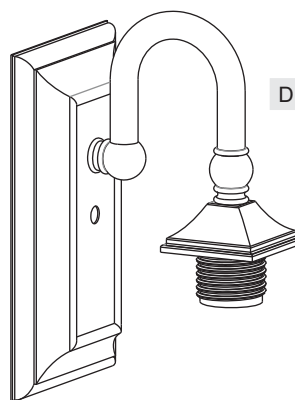

D Fixture Body
x 1

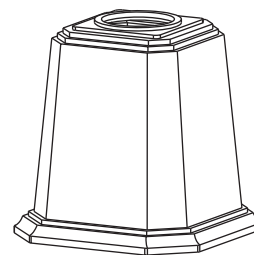

E Shade
x 1



F Socket Collar
x 1

Note: Socket collar shape is for illustration purpose only. Your socket collar shape may vary from illustration.

Table of Contents

Crossbar Assembly

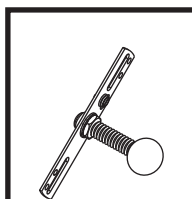

STEP 1

Wiring

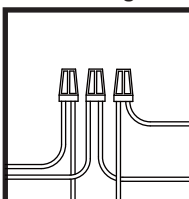

STEP 2

Fixture Body

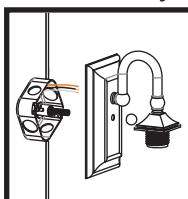

STEP 3

Shade & Bulb

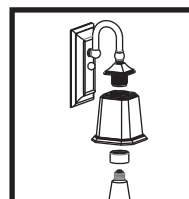

STEP 4

STEP 1

1

Step 1
Install crossbar assembly

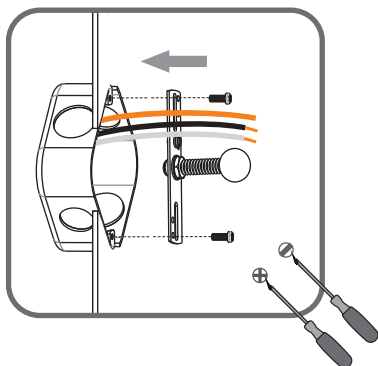

2

Step 2 - 3
Test fitting ceiling canopy to nipple

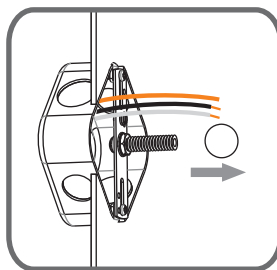

3

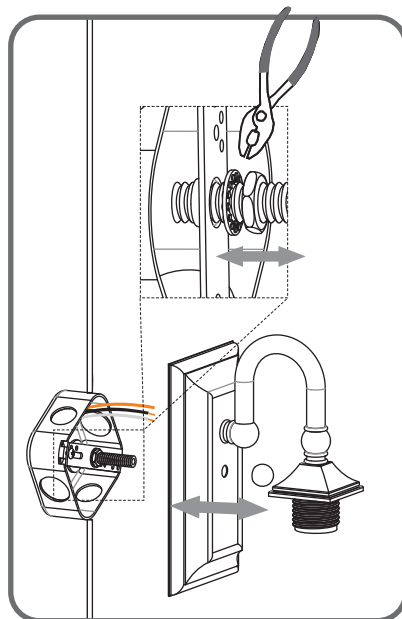

STEP 2

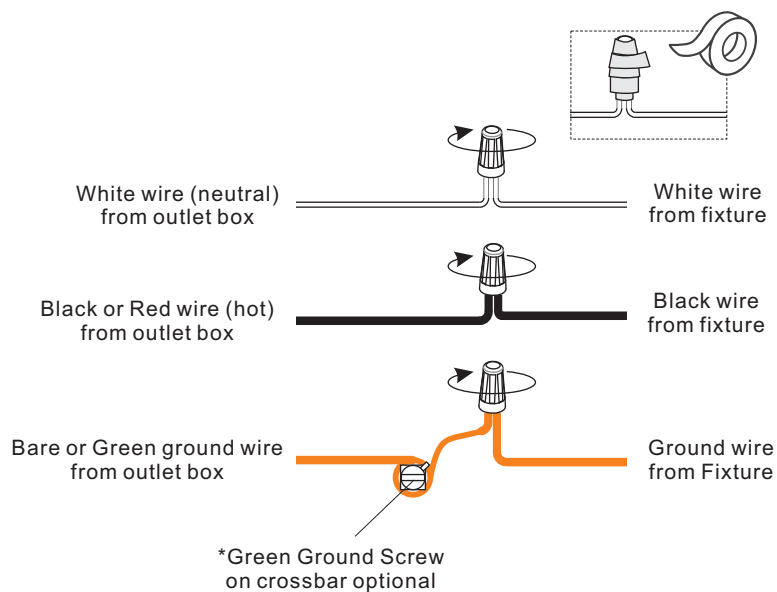

STEP 3

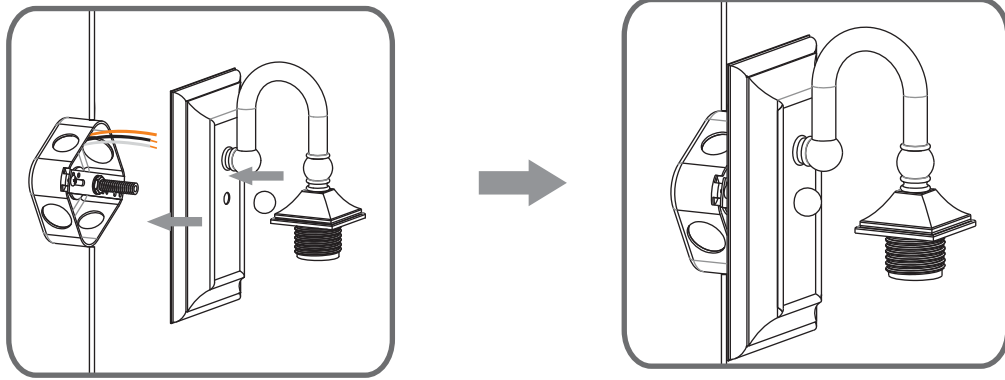

STEP 4

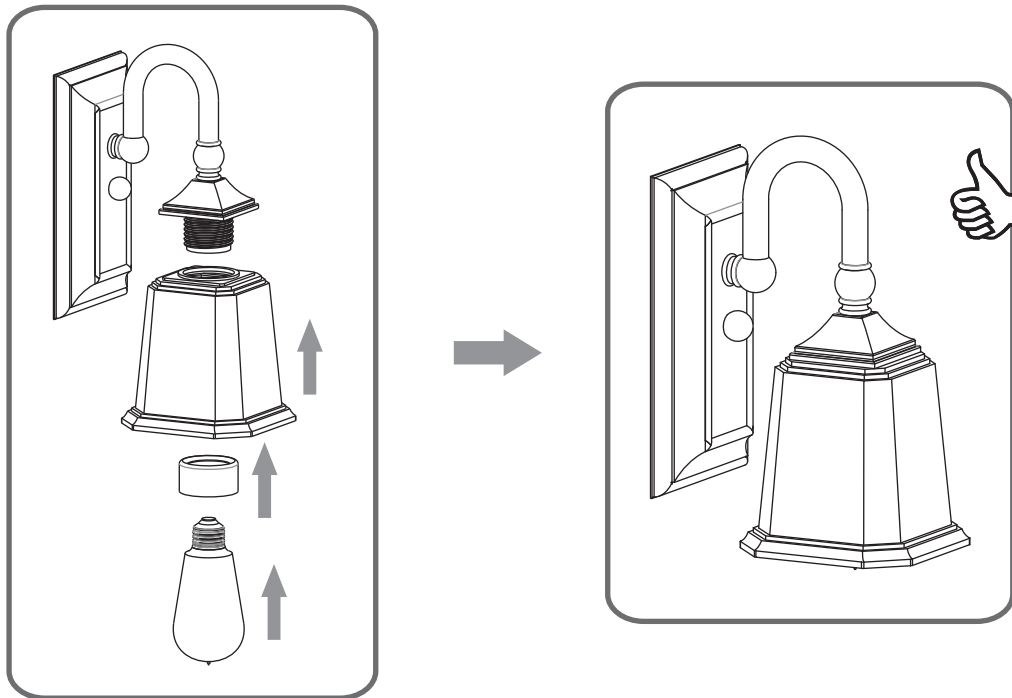

Note: Socket collar shape is for illustration purpose only. Your socket collar shape may vary from illustration.