

INSTALLATION INSTRUCTIONS

For Model 9332-270/661 (New. 01/14/2021)

READ AND SAVE THESE INSTRUCTIONS

WARNING! SHUT POWER OFF AT FUSE OR CIRCUIT BREAKER.

AVERTISSEMENT! COUPER LE COURANT AU NIVEAU DES FUSIBLES OU DU DISJONCTEUR.

HANGING THE FIXTURE (Fig. 1)

1. Shut off power at the fuse box or circuit breaker box and remove the old fixture including the mounting hardware.
2. Carefully unpack your new fixture and lay out all the parts in a clear area. Take care not to misplace any small parts necessary for installation.
3. Attach the circular strap (A) to the outlet box using the two screws (B). The side of the circular strap (A) marked "GND" must face out.
4. Adjust the two mounting screws (C) into the circular strap (A) and space to match the holes in back plate (D).
5. Drill a hole in the wall beside the outlet box and insert the plastic anchor (K).
6. Thread the screw (L) into the plastic anchor (K) until secure and then run the safety cable (Q) through the hole of the screw (L) and the set screw assembly (S). Tighten the screws (R) & (T) as shown in Fig. 1. Carefully allow the support cable (Q) to support the weight of the fixture while wiring.

CONNECTING THE WIRES (Fig. 2)

7. Connect the electrical wires as shown in figure 2, making sure that all wire connectors are secured. If your outlet box has a ground wire (green or bare copper), connect the ground wires from the fixture to it. Otherwise, connect the ground wire from the fixture directly to the circular strap (A) and secure with the green screw provided. After wires are connected, tuck them carefully into the wall outlet box.

COMPLETING THE INSTALLATION (Fig. 1)

8. Place back plate (D) over the two mounting screws (C) and secure with cap nuts (E).
9. Pull up latch (H) and open the door. Attach crystal pentalogs (N) into the holes on the reflector (M).
10. To prevent moisture from entering the outlet box and causing a shortage, use clear caulking (i.e. Indoor/Outdoor silicone sealant) to outline the outside of fixture back plate where it meets the wall leaving a space at the bottom to allow moisture a means to escape (Fig.3).
11. Install (2) two candelabra base bulbs up to 60 watts each or CFL or LED equivalent (not included) in accordance with the fixture specification—**DO NOT EXCEED THE MAXIMUM WATTAGE RATING! (NE PAS DEPASSER LA PUISSANCE NOMINALE MAXIMALE!)**.
12. When replacing the left side glass (F), pull up latch (H) and open the door. Lift tabs and remove the front glass (G) first and then left side glass (F). Next replace left side glass (F) and then front glass (G). Push down tabs to secure glass. Re-latch (H) the door.
13. For installing or replacing bulbs at a later date, pull up latch (H) and open the door. (Fig.1)

Your installation is now complete. Return power to the outlet box and test the fixture.

Note: Illustration (Fig. 1) on this manual is for installation purposes only. It may or may not be identical to the fixture purchased.

Fig.1

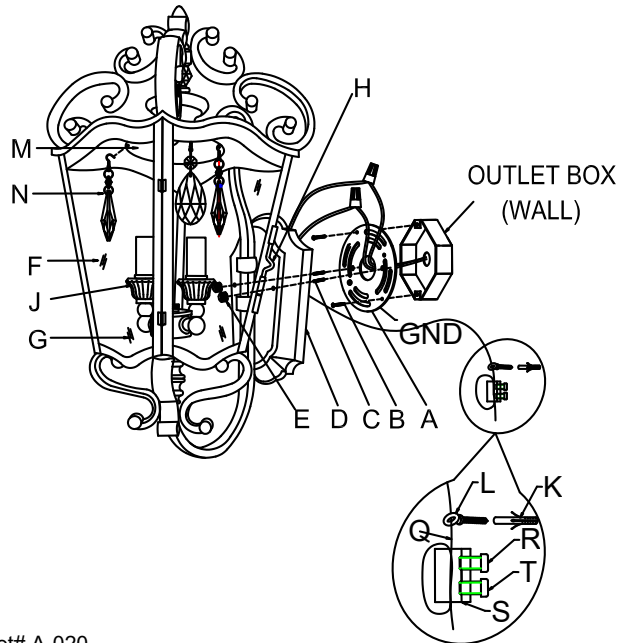

Set# A-020

-Circular Strap

-Ground Screw

-Mounting Screw*2

Candle Cover#CCV21048P-270/661

Fig.2

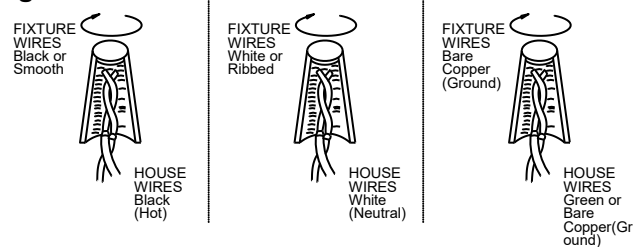
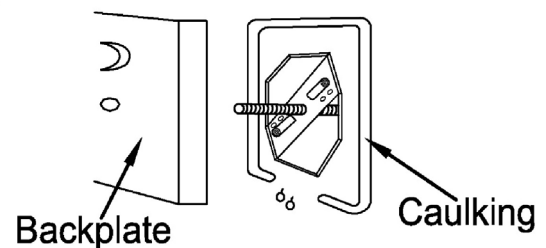

Fig.3



LA-3326E