

# LED Chandelier

**CH14232**  
INSTALLATION SHEET

## START FROM HERE

- Make sure power is completely off at the fuse box.
- Have your fixture installed by a qualified licensed electrician
- Prepare everything in a clear area.
- Wear gloves at all times during this installation.
- Read instructions carefully before you start assembly.
- Keep this instruction sheet for future reference.

**Technical Support:** 1-855-855-8926

### Please Note:

- This Kuzco LED fixture comes with pre-wired LED module(s).
- Unless instructed to do so, please do not touch any part of the LED module(s) as any unnecessary contact with the module could cause permanent damage.
- For dimming, an ELV (Electronic Low Voltage) or TRIAC type of dimmer is required.
- 120V input

- 1.** Remove the fixture from its original packaging. Secure the mounting plate (1c) to the junction box (1a) with the screws (1d) provided in the hardware package. Remove the driver cover (2d) and the canopy end cover (2h) from the canopy (2a) by turning counter clockwise. Make proper electrical connections (black to hot "L", white to neutral "N", ground to "GND") with wire nuts (1b) provided in hardware package. Align the holes in the canopy (2a) to the threaded holes in the mounting plate (1c). Push the canopy up towards the ceiling. Use the screws (2b) to secure the canopy onto the mounting plate.
- 2.** Select the hanging height of the fixture by adding or removing extension rods (2e) from the hardware package. Determine how much wire (2f) is needed from the hub (3a) to the DC driver in the canopy (2a). Connect each rod (2e), starting from the hub (3a) going clockwise while pushing the wires (2f) through each rod until you reach the swivel connector (2c). Before connecting the wires (2f) to the driver, make sure to insert the canopy cover (2d) through the rods (2e). Once the rods are fully connected and wires are pulled into the canopy, connect the wires to the DC driver by using the wire connector (2g) provided. **Black to black and white to white (See Illustration 1 and refer to the diagram on the driver).** Lastly, attach the canopy cover to the canopy by turning clockwise.
- 3.** Next, install the LED spokes (3b) to the center of the fixture hub (3a) by pushing and turning clockwise.
- 4.** You have now completed the installation of your fixture, enjoy.

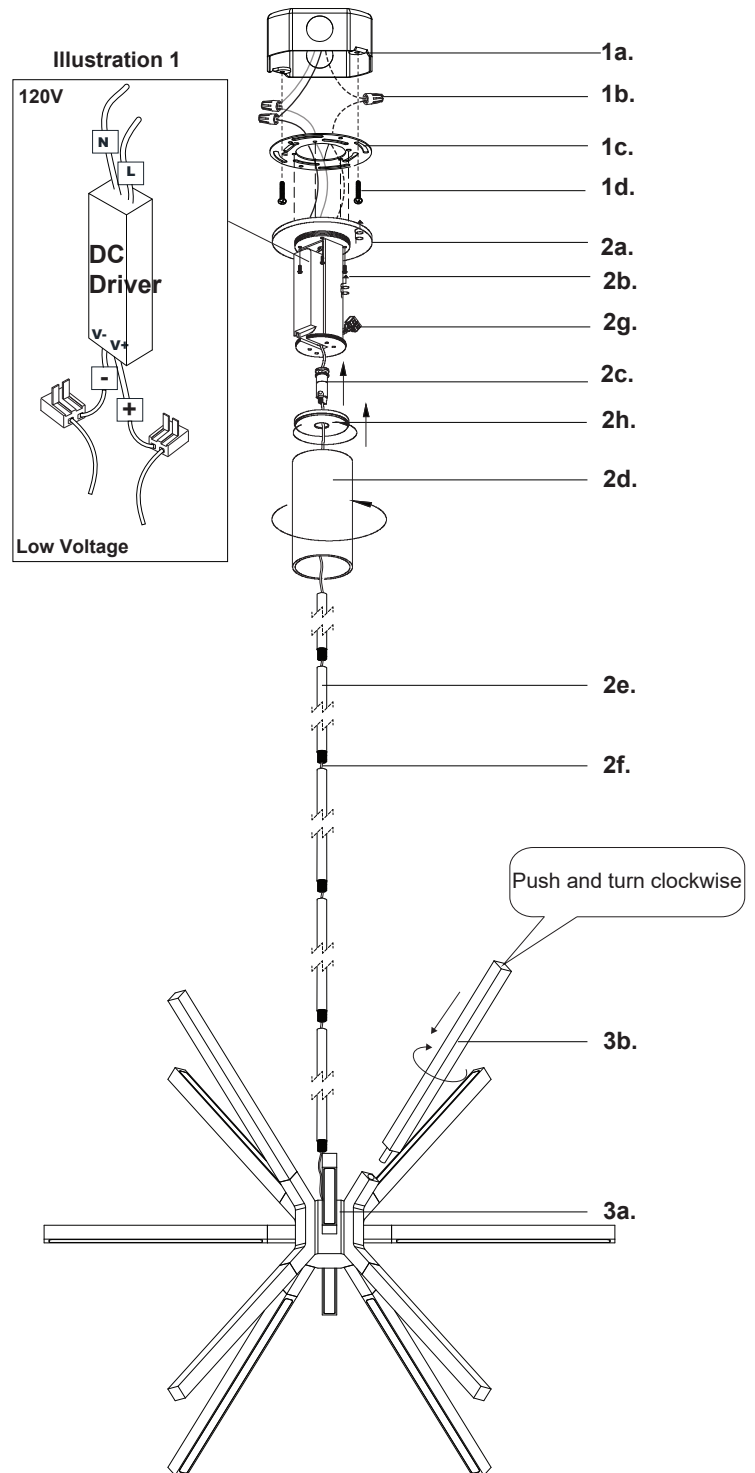

**KUZCO**

19054 28th Avenue Surrey, BC Canada V3Z 6M3  
T: 604 538 7162 TF: 1-855 85 KUZCO F: 604 538 7196  
W: kuzcolighting.com  
20220304