

Family: Frisco | Item No. 4298 RN

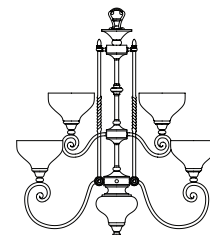

Drawing 1 - Fixture Assembly

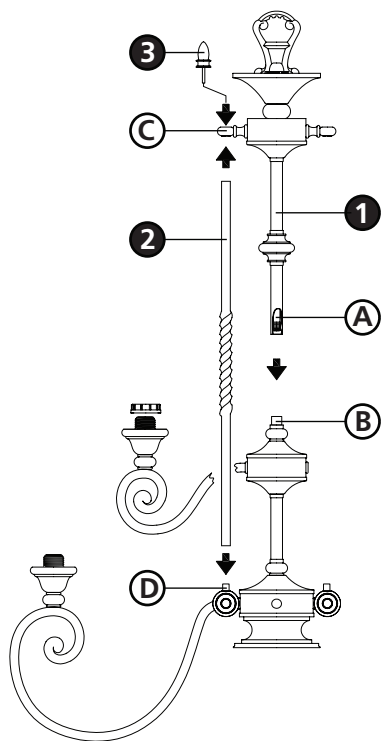

Drawing 2 - Glass Installation

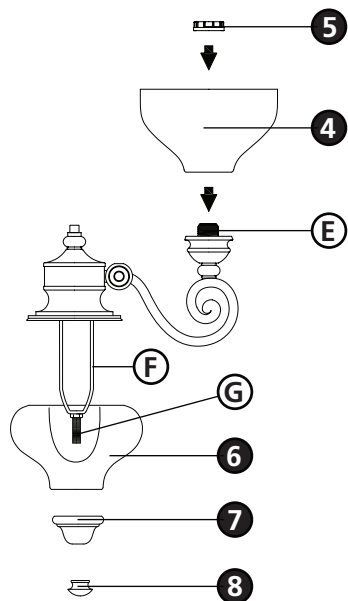

▼ start here

1

1. Find a clear area in which you can work.
2. Unpack fixture and glass from carton.
3. Carefully review instructions prior to assembly.

***** the construction of this fixture will be accomplished by first assembling the main body of the fixture, making all necessary electrical connections, hanging the fixture from the ceiling, and then installing the glass.**

SAFETY WARNING: READ WIRING AND GROUNDING INSTRUCTIONS (I.S. 18) AND ANY ADDITIONAL DIRECTIONS. TURN POWER SUPPLY OFF DURING INSTALLATION. IF NEW WIRING IS REQUIRED, CONSULT A QUALIFIED ELECTRICIAN OR LOCAL AUTHORITIES FOR CODE REQUIREMENTS.

2

1. Slip center column (1) along wire and thread the center tube (A) into coupler (B) and tighten. Making sure the three armatures (C) line up with the three locator pegs (D) - see **Drawing 1**.
2. Slip open end of upright (2) onto locator peg (D).
3. Slip other end of upright (2) under the armature (C).
4. Thread the stud from decorative knob (3) through the armature (C) and into the top of the upright (2) and tighten. Repeat steps 3 and 4 for remaining uprights.
5. Please refer to the hanging instruction sheet (I.S. 19) provided to hang fixture. Then refer back to this sheet to continue installation of this fixture.

3

1. Remove socket ring (5) from socket (E) - see **Drawing 2**.
2. Slip glass (4) over socket (E).
3. Now thread socket ring (5) back on to socket (E) and tighten to secure glass.
4. Entire fixture should now be lamped accordingly.
5. Slip bottom glass (6) over harp (F) and hold in position.
6. Slip bottom cap (7) onto nipple (G) and hold in position.
7. Thread finial (8) onto end of nipple (G) and tighten to secure the glass.

Note: Maximum wattage for 4298 fixture is 60 watts per bulb.
Maximum wattage for lower socket is 7 watts per bulb.

2.7.08