

# INSTALLATION INSTRUCTIONS

Item# P1519-707-L (New. 04/10/2020)

**READ AND SAVE THESE INSTRUCTIONS**

**WARNING! SHUT POWER OFF AT FUSE OR CIRCUIT BREAKER.**

**AVERTISSEMENT! COUPER LE COURANT AU NIVEAU DES FUSIBLES OU DU DISJONCTEUR.**

## PREPARATION (Fig. 1)

1. Shut off the power at the fuse box or circuit breaker. If necessary, remove the existing fixture and its mounting hardware from the ceiling.
2. Carefully unpack your new fixture and lay out all the parts in a clean area. Take care not to misplace any small parts necessary for installation.

## ASSEMBLING THE FIXTURE (Fig. 1&Fig. 3)

3. Insert studs from (K) and (L) into the holes in the glass panels (N) and secure with knobs (G).
4. Pass the wires through the ring (H). Align the studs from (K) into the holes in the ring (H) and secure with knobs (G).
5. Determine the desired hanging height and thread rods (F1, F2 and F3) to all thread (I) on fixture body. Attach canopy (D) by screwing onto rod (F1). Carefully pass the wires through each rod during assembly. Note: Remove the all thread, if installing with one 6" rod only.
6. Cut the excess wire leaving 7" of wire to allow electrical connections and strip 1/2" of the bare cable ends to expose the copper wires.
7. Connect the red wire (positive electrode) from the led driver to the black wire on the fixture. Connect the black wire (negative electrode) from the led driver to the white wire on the fixture. Secure the connections with the small wire connector and wrap the connections with electrical tape for a more secure connection.
8. Thread screws (A) into the pre-drilled holes in the circular strap (B) spaced the same distance apart as the holes in the canopy (D).
9. Attach the circular strap (B) to the junction box using mounting screws (C) (Size: #8-32N\*L0.5"). The side of the circular strap marked "GND" must face out.

## CONNECTING THE WIRES (Fig. 2)

10. Connect the electrical wires as shown in figure 2, making sure that all wire connectors are secured. If your outlet has a ground wire (green or bare copper), connect the fixture's ground wire to it. Otherwise, connect the fixture's ground wire directly to the circular strap (B) using the green screw provided.
11. Tuck the wire connectors neatly into the ceiling junction box and then raise the canopy to the ceiling.

## COMPLETING THE INSTALLATION (Fig. 1)

12. Slide canopy (D) over screws (A) and secure with knurled knobs (E).
13. Put the glass shade (M) over the LED module and secure to the fixture.

Your installation is now complete. Return power to the junction box and test the fixture.

**Note: Illustration (Fig. 1) on this manual is for installation purposes only. It may or may not be identical to the fixture purchased.**

**Dimmable with ELV and/or LED compatible wall dimmer switches.**

**Fig. 1**

Set# A-020

- Circular strap
- Ground screw
- Mounting screw\*2

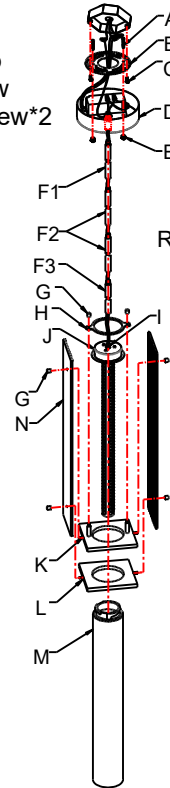

Rod# W30-1-66\*1(F1)  
W30-1-66\*2(F2)  
W30-H-66\*1(F3)

**Fig. 2**



HOUSE WIRES  
Black  
(Hot)



HOUSE WIRES  
White  
(Neutral)

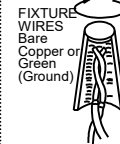

HOUSE WIRES  
Green  
(Ground)

**Fig. 3**

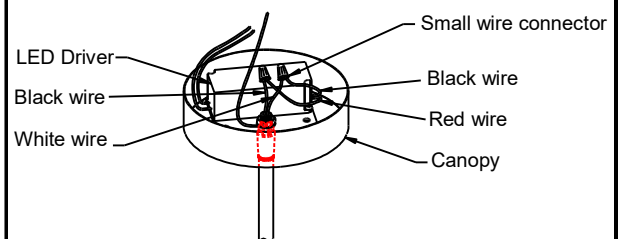

**IMPORTANT: FIXTURE SHOULD BE INSTALLED BY A QUALIFIED ELECTRICIAN TO ENSURE PROPER WIRING AND INSTALLATION.**

LA-3256E



american  
lighting  
association