

CRYST



1958

RAMA

95 Cantiague Rock Road, Westbury NY 11590
 ph: 516.931.9090 fax: 516.931.1254
 info@crystorama.com • www.crystorama.com

MODEL#: 545-SA ASSEMBLY AND DRESSING INSTRUCTIONS



All electrical components must be installed by a licensed electrician in accordance with the National Electric Code and the appropriate local electrical codes.

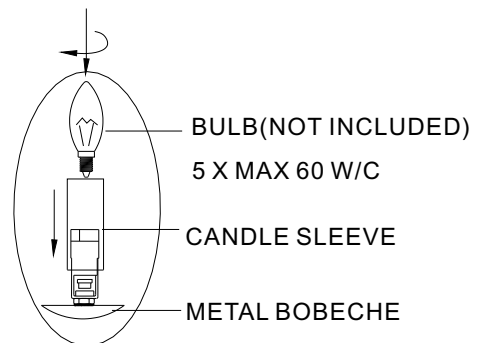
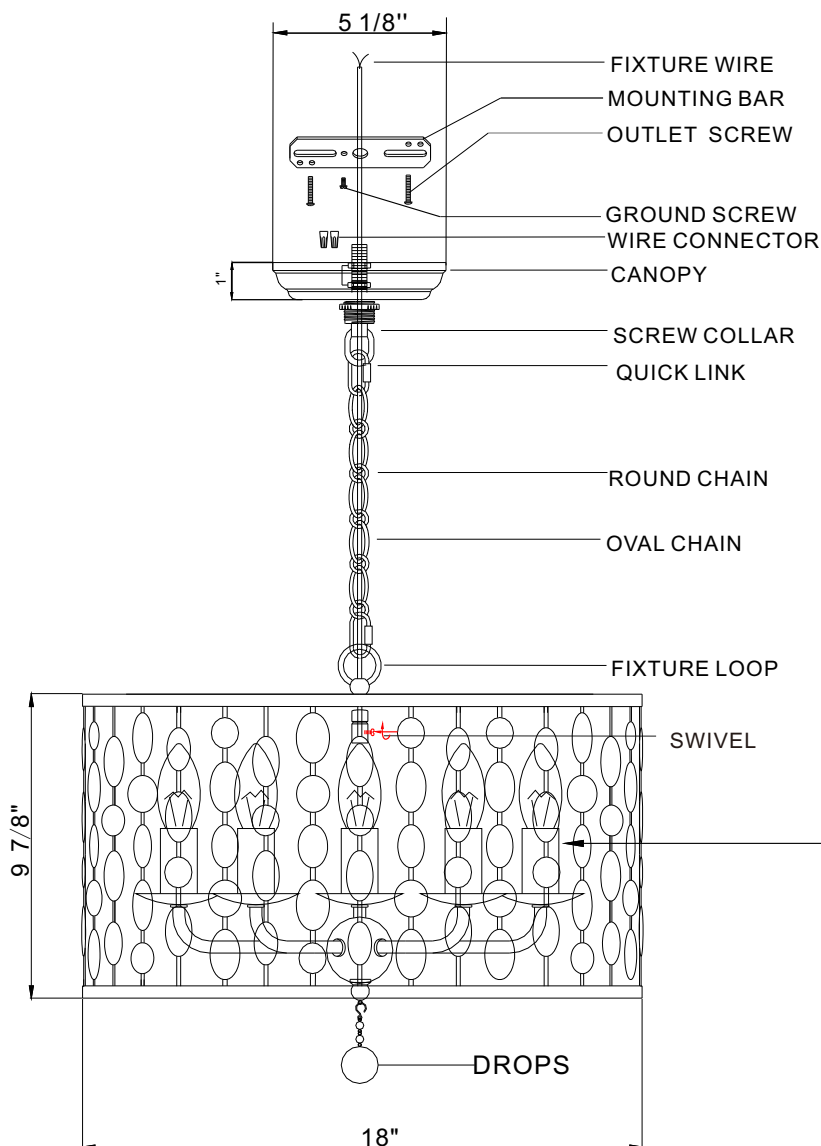

You will need 5- Cand, Bulb
 40 Watts Recommended
 60 Watts Max
 Bulb not included.

DROPS = (10mm brass bead x 2 pcs + 60mm brass bead x 1 pcs) x 1 sets

2014/12